



City of Chapman

**Neighborhood Revitalization
Program**

CITY OF CHAPMAN
NEIGHBORHOOD REVITALIZATION PROGRAM
NOVEMBER 2023

PART 1:
LEGAL DESCRIPTION OF NEIGHBORHOOD REVITALIZATION AREA

Exhibit “A” is a map depicting the proposed neighborhood revitalization area (NRA).
The area includes:

Light Industry District (L-1)(yellow)

North of Irish Drive and west of Marshall Avenue (1202 Manor Drive, 1205 Manor Drive, 1251 Manor Drive, and 0000 Manor Drive)

The Central Business District (B-5)(red)

114 West 4th Street to 138 West 4th Street
112 East 4th Street to 202 East 4th Street
111 West 3rd Street to 117 West 3rd Street
105 East 3rd Street to 131 East 3rd Street
102 East 5th Street to 120 E. 5th Street
401 Marshall Avenue to 445 Marshall Avenue
222 Marshall Avenue to 446 Marshall Avenue

The Highway Business District (B-3)(blue)

202 East 4th Street to 320 East 4th Street
2000 Block, Old Highway 40 (City Vacant Property)
2701 and 2702 Marshall Avenue
910 Marshall Avenue to 1130 Marshall Avenue

South Residential District (R-3) (orange)

100 Block of East 1st Street to 302 East 1st Street
101 East 2nd Street to 318 East 2nd Street
201 East 3rd Street to 237 East 3rd Street
202 Anderson Avenue to 101 Anderson Avenue
222 Noble Avenue to 102 Noble Avenue
100 Block of Marshall Avenue to 209 Marshall Avenue
111 East 5th Street to 302 E. 5th Street

Northeast Residential District (R-3) (orange)

614 Marshall Avenue, 824 Marshall Avenue, and 902 Marshall Avenue
413 Anderson Avenue to 526 Anderson Avenue
421 Noble Avenue to 616 Noble Avenue
211 East 5th Street to 238 East 5th Street
101 East 6th Street to 237 East 6th Street

Northwest Residential District (R-3) (orange)

1009 Manor Drive to 1001 Manor Drive
201 Kimberly Lane to 315 Kimberly Lane
100 Block of West 9th Street to 520 West 9th Street
106 West 8th Street to 538 West 8th Street
102 West 7th Street to 614 West 7th Street
106 West 6th Street to 603 West 6th Street
206 West 5th Street to 733 West 5th Street
202 West 4th Street to 720 West 4th Street
501 Hilltop Drive to 518 Hilltop Drive
501 Crestview Drive to 512 Crestview Drive
500 Block of Cedar Drive to 513 Cedar Drive
503 Meadow Drive to 516 Meadow Drive
516 Golf Course Road
701 Oakhill Drive to 739 Oakhill Drive
401 Nicholson Road to 926 Nicholson Road
702 Hillside Drive to 733 Hillside Drive
437 Stone Lane to 640 Stone Lane
417 Logan Avenue to 913 Logan Avenue
516 Logan Terrace
501 Broadway Avenue to 829 Broadway Avenue
419 Glick Avenue to 829 Glick Avenue
402 Sheeran Avenue to 833 Sheeran Avenue
613 Marshall Avenue to 939 Marshall Avenue
1200 Block St. Patrick's Drive
1206, 1208, 1210, 1213, 1217, and 1218 St. Patrick's Drive

Table 1: Property Assessed Value						
	Lot Value		Improvement Value		Total Valuation	
Area	Total	Average	Total	Average	Total	Average
Light Industrial District	\$432,780.00	\$108,195.00	\$678,000.00	\$169,500.00	\$1,110,780.00	\$277,695.00
Central Business District	\$372,190.00	\$8,271.00	\$1,630,700.00	\$36,238.00	\$2,002,890.00	\$44,509.00
Highway Business District	\$437,040.00	\$25,708.00	\$3,337,810.00	\$196,342.00	\$3,774,850.00	\$222,050.00
Residential District	\$6,048,590.00	\$13,207.00	\$50,904,550.00	\$116,486.00	\$56,953,143.00	\$122,744.00
Total	\$7,290,600.00	\$13756.00	\$56,551,060.00	\$107,922.00	\$63,841,660.00	\$121,835.00
Source:	Dickinson County Appraisers Office Community Development Department December 2023					

PART 2:
EXISTING ASSESSED VALUATIONS OF LAND AND BUILDINGS WITHIN AREA

Table 1 provides an overview of the property values in the city and the existing neighborhood revitalization area. The total valuation of the NRA is approximately \$63,841,660.00 or \$121,835.00 dollars per parcel. These figures include commercial, industrial, residential, and vacant land. A portion of the NRA is located within the floodplain. Therefore, development in these areas may require significant fill for development.

The Central Business District is zoned commercial.

The Highway Business District is zoned commercial.

The Residential District is zoned as multi-family residential.

All districts are in need of renovation based upon the age of each district.

PART 3:
NAMES AND ADDRESSES OF THE OWNERS OF RECORD WITHIN AREA

The names and addresses of the owners of record of real estate within the area are listed in Exhibit "C" and are on file in the office of the City Clerk.

PART 4:
PROPOSALS FOR IMPROVING OR EXPANDING MUNICIPAL SERVICES WITHIN
AREA

The City's long term capital improvement program and/or annual budget identify the following public improvement projects to be performed within the NRA.

Street improvements:

- * The City has developed streets, curb and gutter, and storm drainage improvements for the area immediately south and west of the industrial park. Further street improvements are dependent upon development within the NRA;
- * Routine street maintenance, as needed.

Utilities

- * Utility line maintenance and replacement, as needed;
- * Storm sewer maintenance;
- * Manhole rehabilitation.

Neighborhood improvements:

- * Development of floodplain land including construction of commercial property and/or structures consistent with permitted industrial park development, and business and commercial district development within the NRA;
- * Sidewalk development/replacement program;
- * Code enforcement;
- * Commercial development with the real estate business district.

PART 5
PROPERTY WITHIN THE NEIGHBORHOOD REVITALIZATION AREA ELIGIBLE FOR
PROGRAM TAX REBATE

Commercial, Industrial, and Residential Property:

The following commercial, industrial, and residential projects are eligible for program tax rebates provided the project lies within the NRA and is allowed under the zoning ordinance:

1. Rehabilitation, alterations and additions to any existing commercial, industrial, or residential property; and

2. Construction of new commercial, industrial, and residential structures; provided they are not used for public utility or railroad purposes.

PART 6
CRITERIA FOR DETERMINATION OF PROGRAM ELIGIBILITY

1. Construction of an improvement must commence on or after the 1st day of January 2024, which is the date the neighborhood revitalization program was adopted in the City of Chapman and must be evident by the issuance of a city building permit.
2. An application for a tax rebate must be filed with the City within sixty (60) days of the issuance of a building permit for the subject improvement.
3. The minimum investment in a commercial improvement shall be \$100,000.00 for any vacant lot to be qualified under this program and \$25,000.00 for any existing commercial and residential property to be qualified under this program.
4. The minimum increase and assessed valuation upon completion of the subject improvement shall be not less than 5% for commercial, industrial, and residential properties, as determined by the Dickinson County Appraiser.
5. The construction of a new or the addition to an existing structure shall be eligible if the construction occurs on a tract or portion of a tract which was otherwise vacant at the time of the adoption of the NRA program by the City of Chapman or otherwise meets the minimum investment amount and the minimum increase and assessed valuation amount upon completion of the subject improvement requirement as set forth herein.
6. Property for which any existing taxes or assessments are delinquent shall not be eligible for participation in the program.

PART 7
CONTENTS OF AN APPLICATION FOR PROGRAM PARTICIPATION

The tax rebate application is attached as Appendix D.

PART 8
PROCEDURE FOR SUBMISSION OF AN APPLICATION

1. The applicant shall obtain a tax rebate application from the City of Chapman when obtaining a building permit application for the subject improvement.

2. The applicant shall complete and execute Part 1 of the application and file the application with the City Clerk for the City of Chapman within sixty (60) days of issuance of a building permit for the subject improvements.
3. The City Clerk shall forward the application to the Dickinson County Appraiser for determination of the value of the existing improvements prior to new construction.
4. The City of Chapman shall return the application to the applicant. The applicant shall certify on the application the status of the project as of January 1st following the start of construction by completing and executing Part 2 of the application. The applicant shall file the application with the County Appraiser on or before December 1st preceding the year of the commencement of the applicable tax rebate.
5. The County Appraiser shall on January 1st of the year of the commencement of the tax rebate conduct an inspection of the project to determine the value of new construction and shall report the new valuation to the County Clerk by June 1st. The tax records on the subject tract shall be revised by the County Clerk.
6. Upon determination by the County Appraiser that the improvements meet program criteria for rebate, the Governing Body of the City of Chapman shall determine whether the project meets other criteria for a tax rebate and shall notify the applicant of the rebate percentage each year.
7. Upon payment of the property tax for the subject tract for the initial and each subsequent year through the rebate period, a tax rebate shall be made by the City, County, and USD 473 for each entities apportioned share to the applicant. The rebate shall be made within thirty (30) days following the payment of taxes by the applicant and submittal to the City of a receipt for said payment. The rebate shall be made from the neighborhood revitalization funds of each participating public taxing entity.

PART 9:

STANDARDS AND CRITERIA TO DETERMINE PROGRAM ELIGIBILITY

1. The property for which a rebate is requested shall conform with all applicable city codes and regulations at the time of application and shall remain in conformance for the duration of the rebate period or the rebate may be terminated by the City.
2. Any property on which delinquent taxes or other assessments exist shall not be eligible for a rebate until at such time as those taxes or assessments are paid.

3. Upon establishment of the increase in assessed valuation resulting from the subject improvement, the approved rebate percentage shall be applicable to any future change in assessed value or mill levy during the period of rebate.
4. The Governing Body of the City of Chapman or its designee shall have the authority to determine the eligibility of the applicant. Within thirty (30) days, a written appeal of that determination may be submitted by the applicant to the city council for final determination.

PART 10:
TERMS OF REBATE ELIGIBILITY

Commercial and Industrial Improvements:

Years 1 - 10 100%

Residential Improvements:

Years 1 – 5	100%
Year 6	80%
Year 7	60%
Year 8	40%
Year 9	20%
Year 10	20%

PART 11:
PROGRAM PERIOD

Applications for participation in the Neighborhood Revitalization Program will be accepted by the City of Chapman until December 31, 2028, at which time the program will expire, unless reauthorized by the city council. A report outlining program participation shall be submitted annually by December 31st to the city council. Any application approved for tax rebate prior to December 31, 2028 shall remain eligible to receive the rebate for the number of years specified in its approval.

APPENDIX A NEIGHBORHOOD REVITALIZATION AREA MAP

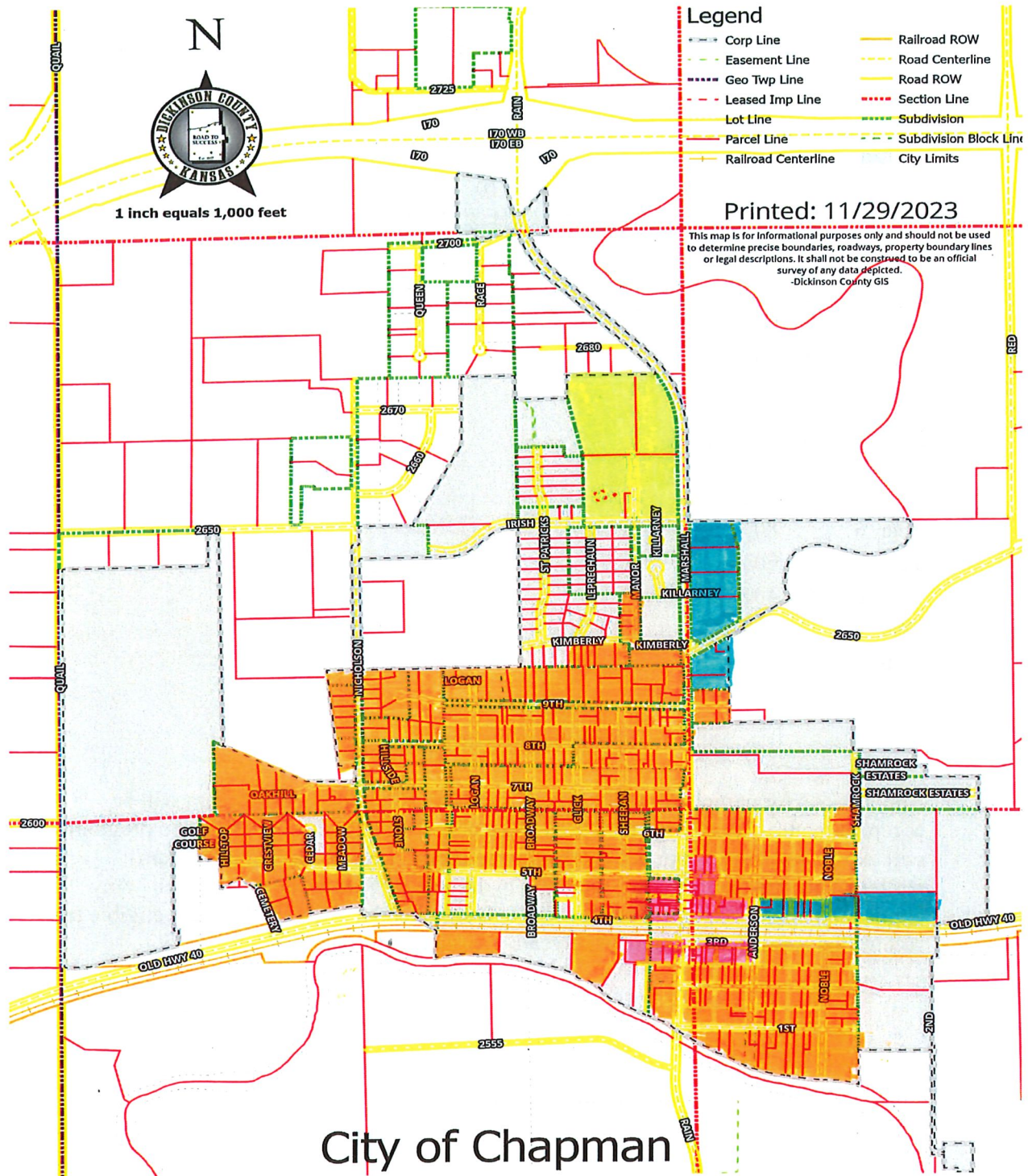

APPENDIX B
NEIGHBORHOOD REVITALIZATION AREA LEGAL DESCRIPTION

(1) Light Industrial District

<u>PIN</u>	<u>Property Type</u>	<u>Property Address</u>
0893001002009040	Commercial & Industrial	0000 Manor Drive
0893001002009010	Vacant	1251 Manor Drive
0893001002009020	Exempt	1205 Manor Drive
0893001002009030	Commercial & Industrial	1202 Manor Drive

(2) Central Business District

<u>PIN</u>	<u>Property Type</u>	<u>Property Address</u>
0893202005008010	Commercial & Industrial	102 East 5th Street
0893202005008000	Exempt	102 East 5th Street
0893202005009000	Residential	114 East 5th Street
0893202005010000	Residential	120 East 5th Street
0893101017001000	Commercial & Industrial	445 Marshall Avenue
0893101017019000	Not for Profit	437 Marshall Avenue
0893101017018000	Commercial & Industrial	433 Marshall Avenue
0893101017017000	Exempt	429 Marshall Avenue
0893101017016000	Commercial & Industrial	425 Marshall Avenue
0893101017015000	Commercial & Industrial	421 Marshall Avenue
0893101017014000	Commercial & Industrial	417 Marshall Avenue
0893101017013000	Exempt	413 Marshall Avenue
0893101017012010	Commercial & Industrial	409 Marshall Avenue
0893101017011000	Commercial & Industrial	401 Marshall Avenue
0893101017010000	Commercial & Industrial	114 West 4th Street
0893101017009020	Commercial & Industrial	122 West 4th Street
0893101017009000	Commercial & Industrial	126 West 4th Street
0893101017009010	Commercial & Industrial	138 West 4th Street
0893202008006000	Exempt	446 Marshall Avenue
0893202008007000	Commercial & Industrial	442 Marshall Avenue
0893202008008000	Commercial & Industrial	428 Marshall Avenue
0893202008009000	Commercial & Industrial	424 Marshall Avenue
0893202008010000	Commercial & Industrial	406 Marshall Avenue
0893202008011000	Exempt	402 Marshall Avenue
0893202008012000	Commercial & Industrial	112 East 4th Street
0893202008013000	Commercial & Industrial	114 East 4th Street
0893202008014000	Utility	116 East 4th Street
0893202008015020	Utility	120 East 4th Street
0893202008015010	Exempt	100 Block East 4th Street

0893202008015000	Vacant	0000 East 4th Street
0893202008005000	Commercial & Industrial	111 East 5th Street
0893101019004000	Commercial & Industrial	117 West 3rd Street
0893101019003000	Commercial & Industrial	115 West 3rd Street
0893101019001000	Commercial & Industrial	113 West 3rd Street
0893101019002000	Vacant	111 West 3rd Street
0893101019005000	Vacant	106 West 3rd Street
0893202009008000	Exempt	222 Marshall Avenue
0893202009007000	Commercial & Industrial	105 East 3rd Street
0893202009006010	Commercial & Industrial	109 East 3rd Street
0893202008006000	Commercial & Industrial	109B East 3rd Street
0893202009005000	Commercial & Industrial	113 East 3rd Street
0893202009004000	Exempt	117 East 3rd Street
0893202009003000	Residential	129 East 3rd Street
0893202009002000	Residential	131 East 3rd Street
0893202009001000	Exempt	221 Anderson Avenue

(3) Highway Business District

<u>PIN</u>	<u>Property Type</u>	<u>Property Address</u>
0841904005002000	Commercial & Industrial	2702 Marshall Avenue
0841904004001000	Commercial & Industrial	2701 Marshall Avenue
0892903001001020	Commercial & Industrial	1130 Marshall Avenue
0892903001001030	Commercial & Industrial	1110 Marshall Avenue
0892903001001040	Commercial & Industrial	1030 Marshall Avenue
0892903001001010	Exempt	2000 Block 2650 Avenue
0892903002002000	Commercial & Industrial	1002 Marshall Avenue
0892903002003000	Commercial & Industrial	910 Marshall Avenue
0893202007008000	Commercial & Industrial	202 East 4th Street
0893202007009000	Vacant	218 East 4th Street
0893202007010000	Residential	222 East 4th Street
0893202007011000	Residential	200 Block East 4th Street
0893202007012000	Residential	230 East 4th Street
0893202007013000	Residential	238 East 4th Street
0893202001006000	Residential	302 East 4th Street
0893202001001000	Exempt	320 East 4th Street
0893200000002020	Agriculture Use	2000 Block Old Highway 40

(4) Residential Districts (South)

<u>PIN</u>	<u>Property Type</u>	<u>Property Address</u>
0893202014009000	Vacant	100 Block East 1st Street
0893202014010000	Residential	101 Anderson Avenue
0893202012023000	Commercial & Industrial	00000 East 1st Street
0893202012023010	Residential	121 East 1st Street
0893202012022000	Residential	129 East 1st Street
0893202012021000	Residential	205 East 1st Street
0893202012020000	Residential	209 East 1st Street
0893202012019000	Residential	213 East 1st Street
0893202012018000	Residential	217 East 1st Street
0893202012017000	Residential	221 East 1st Street
0893202012016000	Vacant	00000 East 1st Street
0893202012015000	Residential	233 East 1st Street
0893202012014000	Residential	237 East 1st Street
0893202012013000	Farm Homesite	301 East 1st Street
0893202014010010	Residential	109 Anderson Avenue
0893202013009000	Residential	102 Anderson Avenue
0893202013008000	Residential	110 Anderson Avenue
0893202013010000	Residential	210 East 1st Street
0893202013011000	Residential	216 East 1st Street
0893202013012000	Residential	222 East 1st Street
0893202013013000	Residential	226 East 1st Street
0893202013014000	Residential	232 East 1st Street
0893202013015000	Residential	115 Noble Avenue
0893202012011000	Residential	102 Noble Avenue
0893202012011010	Residential	302 East 1st Street
0893202012010000	Residential	110 Noble Avenue
0893202014008000	Residential	101 East 2nd Street
0893202014007000	Residential	105 East 2nd Street
0893202014006000	Residential	107 East 2nd Street
0893202014005000	Residential	117 East 2nd Street
0893202014003000	Residential	127 East 2nd Street
0893202014002000	Residential	129 East 2nd Street
0893202014001000	Residential	121 Anderson Avenue
0893202013007000	Residential	201 East 2nd Street
0893202013006000	Residential	205 East 2nd Street
0893202013005000	Residential	209 East 2nd Street
0893202013004000	Residential	217 East 2nd Street
0893202013003000	Residential	221 East 2nd Street
0893202013002000	Residential	229 East 2nd Street
0893202013001000	Residential	237 East 2nd Street
0893202012009000	Residential	118 Noble Avenue
0893202012008000	Residential	122 Noble Avenue

0893202012007000	Residential	313 East 2nd Street
0893202012006000	Residential	318 East 2nd Street
0893202012005000	Residential	202 Noble Avenue
0893202010012000	Residential	201 Noble Avenue
0893202010011000	Residential	230 East 2nd Street
0893202010010000	Residential	222 East 2nd Street
0893202010009000	Residential	214 East 2nd Street
0893202010008000	Residential	210 East 2nd Street
0893202010007000	Residential	202 Anderson Avenue
0893202009017000	Residential	138 East 2nd Street
0893202009016000	Residential	136 East 2nd Street
0893202009015000	Residential	134 East 2nd Street
0893202009014000	Residential	128 East 2nd Street
0893202009013000	Residential	122 East 2nd Street
0893202009012000	Residential	118 East 2nd Street
0893202009011000	Residential	114 East 2nd Street
0893202009010000	Residential	110 East 2nd Street
0893202009009000	Residential	102 East 2nd Street
0893202010006000	Exempt	201 East 3rd Street
0893202010005000	Vacant	00000 East 3rd Street
0893202010004000	Residential	217 East 3rd Street
0893202010003000	Residential	225 East 3rd Street
0893202010002000	Residential	231 East 3rd Street
0893202010001000	Residential	237 East 3rd Street
0893202012003000	Residential	222 Noble Avenue
0893202012004000	Residential	218 Noble Avenue
0893101019016000	Residential	209 Marshall Avenue
0893101019015000	Residential	201 Marshall Avenue
0893101019014000	Residential	100 Block Marshall Avenue

Residential Districts (Northeast)

0893202008003000	Residential	125 East 5th Street
0893202008001010	Residential	129 East 5th Street
0893202008016000	Residential	413 Anderson Avenue
0893202008001000	Residential	137 East 5th Street
0893202007006000	Residential	420 Anderson Avenue
0893202007005000	Residential	211 East 5th Street
0893202007004000	Residential	217 East 5th Street
0893202007003000	Residential	221 East 5th Street
0893202007002000	Residential	225 East 5th Street
0893202007001000	Residential	421 Noble Avenue
0893202001005000	Residential	422 Noble Avenue
0893202001004000	Residential	302 East 5th Street
0893202006012000	Residential	238 East 5th Street

0893202006011000	Residential	228 East 5th Street
0893202006010000	Residential	226 East 5th Street
0893202006009000	Residential	218 East 5th Street
0893202006008000	Residential	214 East 5th Street
0893202006007000	Residential	502 Anderson Avenue
0893202005013000	Residential	138 East 5th Street
0893202005012000	Vacant	130 East 5th Street
0893202005011000	Residential	122 East 5th Street
0893202005007000	Residential	101 East 6th Street
0893202005006000	Residential	109 East 6th Street
0893202005005000	Residential	117 East 6th Street
0893202005004000	Residential	121 East 6th Street
0893202005002000	Residential	127 East 6th Street
0893202005001000	Residential	137 East 6th Street
0893202006006000	Residential	526 Anderson Avenue
0893202006005000	Residential	211 East 6th Street
0893202006004000	Residential	213 East 6th Street
0893202006003000	Residential	226 East 6th Street
0893202006002000	Residential	229 East 6th Street
0893202006001000	Residential	237 East 6th Street
0893202001003000	Residential	514 Noble Avenue
0893202001002000	Residential	522 Noble Avenue
0893202002001010	Residential	606 Noble Avenue
0893202002001000	Residential	616 Noble Avenue
0893202003001000	Exempt	210 East 6th Street
0893202004001000	Residential	138 East 6th Street
0893202004002000	Residential	132 East 6th Street
0893202004003000	Residential	130 East 6th Street
0893202004004000	Residential	122 East 6th Street
0893202004005000	Residential	118 East 6th Street
0893202004006000	Residential	110 East 6th Street
0893202004009000	Residential	102 East 6th Street
0893202004008000	Vacant	614 Marshall Avenue
0892903002009000	Residential	824 Marshall Avenue
0892903002008000	Residential	109 East 9th Street
0892903002005000	Residential	902 Marshall Avenue
0892903002006000	Residential	106 East 9th Street
0892903002007000	Residential	110 East 9th Street

Residential Districts (Northwest)

0893004001037000	Vacant	00000 Manor Drive
0893004001036000	Residential	1009 Manor Drive
0893004001035000	Residential	1005 Manor Drive
0893004001034000	Residential	1001 Manor Drive

0893004001031000	Residential	929 Marshall Avenue
0893004001032000	Residential	201 Kimberly Lane
0893004001032010	Residential	105 Kimberly Lane
0893004001033000	Residential	301 Kimberly Lane
0893004001033020	Residential	305 Kimberly Lane
0893004001033010	Residential	309 Kimberly Lane
0893004001033070	Residential	315 Kimberly Lane
0893004001030000	Residential	917 Marshall Avenue
0893004001029000	Residential	114 West 9th Street
0893004001028010	Residential	126 West 9th Street
0893004001028000	Residential	132 West 9th Street
0893004001027000	Residential	146 West 9th Street
0893004001026000	Residential	206 West 9th Street
0893004001026010	Residential	00000 West 9th Street
0893004001025000	Residential	222 West 9th Street
0893004001024000	Residential	238 West 9th Street
0893004001023000	Residential	300 West 9th Street
0893004001022000	Residential	320 West 9th Street
0893004001021000	Residential	330 West 9th Street
0893004001020000	Residential	402 West 9th Street
0893004001019000	Residential	416 West 9th Street
0893004001018000	Residential	438 West 9th Street
0893004001015000	Residential	901 Logan Avenue
0893004001017000	Residential	913 Logan Avenue
0893004001016000	Residential	516 Logan Terrace
0893004001002000	Residential	506 West 9th Street
0893004001002020	Residential	508 West 9th Street
0893004001002200	Residential	520 West 9th Street
0893004001002230	Residential	513 West 9th Street
0893004001002010	Residential	511 West 9th Street
0893004001002220	Residential	509 West 9th Street
0893004001002050	Residential	507 West 9th Street
0893004001014000	Residential	829 Logan Avenue
0893004001013000	Residential	821 Logan Avenue
0893004003002000	Residential	435 West 9th Street
0893004003003000	Residential	818 Logan Avenue
0893004003001010	Residential	400 Block West 9th Street
0893004003001000	Residential	829 Broadway Avenue
0893004003008010	Residential	817 Broadway Avenue
0893004004003000	Residential	329 West 9th Street
0893004004004000	Residential	820 Broadway Avenue
0893004004002000	Residential	327 West 9th Street
0893004004001000	Residential	829 Glick Avenue
0893004005002000	Residential	225 West 9th Street
0893004005002010	Residential	822 Glick Avenue

0893004006004000	Residential	141 West 9th Street
0893004006005000	Residential	833 Sheeran Avenue
0893004006003000	Vacant	100 Block West 9th Street
0893004006002000	Residential	121 West 9th Street
0893004006014000	Vacant	100 Block West 9th Street
0893004006001000	Residential	825 Marshall Avenue
0893004006013000	Residential	100 Block West 9th Street
0893004006012000	Residential	817 Marshall Avenue
0893004006010010	Residential	815 Marshall Avenue
0893004006010000	Residential	106 West 8th Street
0893004006009000	Residential	108 West 8th Street
0893004006007000	Residential	138 West 8th Street
0893004006006000	Residential	146 West 8th Street
0893004005006000	Residential	214 West 8th Street
0893004005005000	Residential	222 West 8th Street
0893004005004000	Residential	226 West 8th Street
0893004005003000	Residential	230 West 8th Street
0893004004008000	Residential	823 Glick Avenue
0893004004007000	Residential	318 West 8th Street
0893004004005000	Residential	326 West 8th Street
0893004003007000	Residential	801 Broadway Avenue
0893004003006000	Residential	414 West 8th Street
0893004003005000	Residential	422 West 8th Street
0893004003004000	Residential	438 West 8th Street
0893004001012000	Residential	805 Logan Avenue
0893004001011000	Residential	518 West 8th Street
0893004001002060	Residential	522 West 8th Street
0893004001002070	Residential	526 West 8th Street
0893004001002040	Residential	530 West 8th Street
0893004001002190	Residential	534 West 8th Street
0893004001002100	Residential	538 West 8th Street
0893004001004000	Residential	733 Hillside Drive
0893004001005000	Residential	721 Hillside Drive
0893004001006000	Residential	713 Hillside Drive
0893004001007000	Residential	614 West 7th Street
0893004001008000	Residential	608 West 7th Street
0893004001009000	Residential	602 West 7th Street
0893004011009000	Residential	702 Hillside Drive
0893004011008000	Residential	712 Hillside Drive
0893004011007000	Residential	722 Hillside Drive
0893004011006000	Residential	537 West 8th Street
0893004011005000	Residential	533 West 8th Street
0893004011004000	Residential	529 West 8th Street
0893004011003000	Residential	525 West 8th Street
0893004011002000	Residential	513 West 8th Street

0893004011001000	Residential	505 West 8th Street
0893004011014000	Residential	725 Logan Avenue
0893004010006000	Residential	437 West 8th Street
0893004010007000	Residential	724 Logan Avenue
0893004010005000	Residential	429 West 8th Street
0893004010004000	Residential	425 West 8th Street
0893004010003000	Residential	417 West 8th Street
0893004010001000	Residential	728 Broadway Avenue
0893004009004000	Residential	734 Broadway Avenue
0893004009003000	Residential	321 West 8th Street
0893004009002000	Residential	303 West 8th Street
0893004009001000	Residential	301 West 8th Street
0893004008004000	Residential	734 Glick Avenue
0893004008003000	Residential	219 West 8th Street
0893004008002000	Residential	205 West 8th Street
0893004008001000	Residential	727 Sheeran Avenue
0893004008009000	Residential	725 Sheeran Avenue
0893004007006000	Vacant	700 Block Sheeran Avenue
0893004007006010	Residential	730 Sheeran Avenue
0893004007004000	Residential	133 West 8th Street
0893004007003000	Residential	125 West 8th Street
0893004007002000	Residential	117 West 8th Street
0893004007001000	Vacant	725 Marshall Avenue
0893004007011000	Vacant	723 Marshall Avenue
0893004007010000	Vacant	102 West 7th Street
0893004007009000	Residential	118 West 7th Street
0893004007008000	Residential	130 West 7th Street
0893004007007000	Vacant	142 West 7th Street
0893004008008000	Residential	723 Sheeran Avenue
0893004008007000	Residential	701 Sheeran Avenue
0893004008006000	Residential	214 West 7th Street
0893004008005000	Residential	230 West 7th Street
0893004009008000	Vacant	302 West 7th Street
0893004009007000	Residential	310 West 7th Street
0893004009006000	Residential	318 West 7th Street
0893004009005000	Residential	330 West 7th Street
0893004010010000	Residential	701 Broadway Avenue
0893004010009000	Residential	426 West 7th Street
0893004010008000	Residential	438 West 7th Street
0893004011013000	Residential	705 Logan Avenue
0893004011012000	Residential	510 West 7th Street
0893004011011000	Residential	520 West 7th Street
0893004011010000	Residential	524 West 7th Street
0893004012002000	Residential	609 West 7th Street
0893004012001000	Residential	633 Stone Lane

0893004012003000	Residential	630 Nicholson Road
0893101006002000	Residential	614 Nicholson Road
0893101006003010	Residential	500 Block Nicholson Road
0893004012004000	Residential	629 Stone Lane
0893101006001000	Residential	613 Stone Lane
0893101006003000	Residential	601 Stone Lane
0893101006004000	Residential	525 Stone Lane
0893101006005000	Residential	513 Stone Lane
0893101006006000	Residential	507 Stone Lane
0893101005007000	Residential	502 Stone Lane
0893101005006000	Residential	603 West 6th Street
0893101005005000	Residential	612 Stone Lane
0893004013007000	Residential	622 Stone Lane
0893004013006000	Residential	640 Stone Lane
0893004013005000	Residential	523 West 7th Street
0893004013004000	Residential	521 West 7th Street
0893004013003000	Vacant	51 West 7th Street
0893004013002000	Residential	513 West 7th Street
0893004013001000	Residential	633 Logan Avenue
0893004013008000	Residential	625 Logan Avenue
0893004014003000	Residential	630 Logan Avenue
0893004014003010	Residential	425 West 7th Street
0893004014002000	Residential	413 West 7th Street
0893004014001000	Residential	633 Broadway Avenue
0893004014004000	Residential	625 Broadway Avenue
0893004015003000	Residential	634 Broadway Avenue
0893004015004000	Residential	626 Broadway Avenue
0893004015002000	Residential	313 West 7th Street
0893004015001000	Residential	629 Glick Avenue
0893004015005000	Residential	625 Glick Avenue
0893004016002000	Residential	634 Glick Avenue
0893004016003000	Residential	622 Glick Avenue
0893004016001000	Residential	629 Sheeran Avenue
0893004017004000	Residential	628 Sheeran Avenue
0893004017003000	Vacant	133 West 7th Street
0893004017002000	Residential	121 West 7th Street
0893004017001000	Residential	115 West 7th Street
0893004017001010	Residential	625 Marshall Avenue
0893004017005000	Residential	617 Marshall Avenue
0893101001001000	Residential	613 Marshall Avenue
0893101001006000	Residential	106 West 6th Street
0893101001002000	Vacant	118 West 6th Street
0893101001003000	Residential	614 Sheeran Avenue
0893101001005000	Residential	126 West 6th Street
0893101002001000	Residential	206 West 6th Street

0893101002002000	Residential	214 West 6th Street
0893101002003000	Vacant	222 West 6th Street
0893101002004000	Residential	230 West 6th Street
0893101003001000	Residential	607 Glick Avenue
0893101003004000	Residential	601 Glick Avenue
0893101003002000	Residential	320 West 6th Street
0893101003003010	Residential	330 West 6th Street
0893101004001000	Residential	609 Broadway Avenue
0893101004007000	Vacant	601 Broadway Avenue
0893101004002000	Residential	410 West 6th Street
0893101004003000	Residential	418 West 6th Street
0893101004004000	Residential	422 West 6th Street
0893101004005000	Residential	430 West 6th Street
0893101004006000	Residential	610 Logan Avenue
0893101005001000	Residential	613 Logan Avenue
0893101005019000	Residential	601 Logan Avenue
0893101005002000	Residential	514 West 6th Street
0893101005003000	Residential	526 West 6th Street
0893101005004000	Residential	534 West 6th Street
0893101005018000	Residential	525 West 6th Street
0893101005017000	Residential	521 West 6th Street
0893101005016000	Residential	525 Logan Avenue
0893101005015000	Residential	521 Logan Avenue
0893101005014000	Residential	517 Logan Avenue
0893101005013000	Residential	509 Logan Avenue
0893101011005000	Residential	526 Logan Avenue
0893101011004000	Residential	425 West 6th Street
0893101011003000	Residential	417 West 6th Street
0893101011002000	Residential	415 West 6th Street
0893101011001000	Residential	529 Broadway Avenue
0893101011012000	Residential	521 Broadway Avenue
0893101014002000	Residential	530 Broadway Avenue
0893101014003000	Residential	518 Broadway Avenue
0893101014004000	Residential	514 Broadway Avenue
0893101014001000	Vacant	529 Glick Avenue
0893101014010000	Residential	521 Glick Avenue
0893101014009000	Residential	515 Glick Avenue
0893101015002000	Residential	227 West 6th Street
0893101015005000	Vacant	518 Glick Avenue
0893101015001000	Residential	529 Sheeran Avenue
0893101015010000	Residential	517 Sheeran Avenue
0893101015010020	Vacant	500 Block Sheeran Avenue
0893101018002000	Residential	526 Sheeran Avenue
0893101018003000	Residential	518 Sheeran Avenue
0893101018004000	Exempt	516 Sheeran Avenue

0893101015008000	Commercial & Industrial	206 West 5th Street
0893101015007000	Vacant	210 West 5th Street
0893101015006000	Residential	506 Glick Avenue
0893101014008000	Residential	302 West 5th Street
0893101014007000	Vacant	310 West 5th Street
0893101014006000	Vacant	324 West 5th Street
0893101014005000	Residential	502 Broadway Avenue
0893101011011000	Residential	501 Broadway Avenue
0893101011010000	Residential	406 West 5th Street
0893101011009000	Residential	410 West 5th Street
0893101011008000	Residential	422 West 5th Street
0893101011007000	Residential	436 West 5th Street
0893101011006000	Residential	438 West 5th Street
0893101005012000	Exempt	505 Logan Avenue
0893101005011000	Exempt	516 West 5th Street
0893101005010000	Residential	522 West 5th Street
0893101005009000	Residential	530 West 5th Street
0893101005008000	Residential	538 West 5th Street
0893101016001000	Residential	429 Sheeran Avenue
893101016009000	Residential	417 Sheeran Avenue
0893101016003000	Residential	225 West 5th Street
0893101016004000	Residential	422 Glick Avenue
0893101013001000	Residential	311 West 5th Street
0893101013008000	Residential	419 Glick Avenue
0893101013002000	Residential	313 West 5th Street
0893101010004000	Residential	525 West 5th Street
0893101010005000	Residential	529 West 5th Street
0893101010006000	Residential	545 West 5th Street
0893101009001000	Residential	437 Stone Lane
0893101009002000	Residential	425 Nicholson Road
0893101009003000	Residential	413 Nicholson Road
0893101009004000	Residential	401 Nicholson Road
0893101010006010	Residential	500 Block West 4th Street
0893101010007000	Residential	522 West 4th Street
0893101016005000	Residential	222 West 4th Street
0893101016006000	Residential	210 West 4th Street
0893101016008000	Residential	415 Sheeran Avenue
0893101016007000	Residential	202 West 4th Street
0893101017005000	Residential	414 Sheeran Avenue
0893101017006000	Residential	412 Sheeran Avenue
0893101017007000	Residential	402 Sheeran Avenue
0893101008001000	Exempt	701 West 5th Street
0893102002011000	Residential	704 West 4th Street
0893102002009000	Residential	712 West 4th Street
0893102002008010	Residential	716 West 4th Street

0893102002008020	Residential	720 West 4th Street
0893102002008000	Residential	722 West 4th Street
0893102002001000	Residential	703 West 5th Street
0893102002002000	Residential	715 West 5th Street
0893102002003000	Residential	719 West 5th Street
0893102002004000	Residential	721 West 5th Street
0893102002005000	Residential	723 West 5th Street
0893102002006000	Vacant	700 Block West 5th Street
0893102002007000	Residential	729 West 5th Street
0893102001030000	Residential	733 West 5th Street
0893102001026010	Residential	516 Golf Course Road
0893102001025000	Residential	518 Hilltop Drive
0893102001024000	Residential	514 Hilltop Drive
0893102001023000	Residential	508 Hilltop Drive
0893102001022000	Residential	728 West 5th Street
0893102001021000	Residential	501 Crestview Drive
0893102001020000	Residential	503 Crestview Drive
0893102001019000	Residential	505 Crestview Drive
0893102001018000	Residential	506 Crestview Drive
0893102001017000	Residential	508 Crestview Drive
0893102001016000	Residential	510 Crestview Drive
0893102001015000	Residential	512 Crestview Drive
0893102001014000	Vacant	500 Block Cedar Drive
0893102001013000	Residential	509 Cedar Drive
0893102001012000	Residential	513 Cedar Drive
0893102001010000	Residential	502 Cedar Drive
0893102001009000	Residential	503 Meadow Drive
0893102001008000	Residential	505 Meadow Drive
0893102001007000	Residential	509 Meadow Drive
0893102001006000	Residential	513 Meadow Drive
0893102001005000	Residential	516 Meadow Drive
0893102001004000	Residential	514 Meadow Drive
0893102001003000	Residential	510 Meadow Drive
0893102001002000	Residential	508 Meadow Drive
0893102001001000	Residential	506 Meadow Drive
0893003002010000	Residential	629 Nicholson Road
0893003002011000	Residential	701 Oakhill Drive
0893003002012000	Residential	711 Oakhill Drive
0893003002009000	Residential	715 Oakhill Drive
0893003002008000	Residential	719 Oakhill Drive
0893003002007000	Residential	723 Oakhill Drive
0893003002006000	Residential	727 Oakhill Drive
0893003002005000	Residential	733 Oakhill Drive
0893003002004000	Residential	739 Oakhill Drive
0893003002003000	Residential	738 Oakhill Drive

0893003002002000	Residential	728 Oakhill Drive
0893003002001000	Residential	722 Oakhill Drive
0893003001002040	Residential	821 Nicholson Road
0893003001005000	Residential	823 Nicholson Road
0893003001006000	Residential	835 Nicholson Road
0893003001007000	Residential	837 Nicholson Road
0893003001008020	Residential	901 Nicholson Road
0893003001008010	Residential	911 Nicholson Road
0893003001008000	Vacant	00000 Nicholson Road
0893003001009000	Residential	919 Nicholson Road
0893004001002130	Residential	926 Nicholson Road
0893004001002210	Residential	924 Nicholson Road
0893004001002150	Residential	922 Nicholson Road
0893004001002160	Residential	916 Nicholson Road
0893004001002170	Residential	910 Nicholson Road
0893004001002180	Residential	832 Nicholson Road
0893004001002090	Residential	828 Nicholson Road
0893001002009000	Vacant	1200 Block, St. Patrick's Drive
0893001002009120	Vacant	1217 St. Patrick's Drive
0893001002009180	Vacant	1218 St. Patrick's Drive
0893001002009100	Vacant	1213 St. Patrick's Drive
0893001002009160	Vacant	1210 St. Patrick's Drive
0893001002009150	Vacant	1208 St. Patrick's Drive
0893001002009140	Vacant	1206 St. Patrick's Drive

EXHIBIT "C"
NAMES AND ADDRESSES OF OWNERS OF RECORD WITHIN AREA
AND CURRENT APPRAISED VALUE

Light Industry District (L-1)				
Name	Address	Lot Value	Improvements	Total
Kansas Auto Racing Museum, Inc.	1202 Manor Dr., Chapman, Kansas	\$ 151,020.00	\$ 432,470.00	\$ 583,490.00
Kansas Auto Racing Museum, Inc.	1205 Manor Dr., Chapman, Kansas	\$ 215,120.00	\$ 239,580.00	\$ 454,700.00
Douglas Thompson	1251 Manor Dr., Chapman, Kansas	\$ 30,190.00	\$ -	\$ 30,190.00
Douglas Thompson	00000 Manor Dr., Chapman, Kansas	\$ 36,450.00	\$ 5,950.00	\$ 42,400.00
Highway Business District (B-3)				
Name	Address	Lot Value	Improvements	Total
Chapman Creek RV Park, LLC	2701 Marshall Ave., Chapman, Kansas	\$ 42,400.00	\$ 129,110.00	\$ 171,510.00
JCD Rentals, LLC (La Hacienda)	2702 Marshall Ave., Chapman, Kansas	\$ 7,200.00	\$ 186,150.00	\$ 193,350.00
Astra Bank	1130 Marshall Ave., Chapman, Kansas	\$ 20,000.00	\$ 513,600.00	\$ 533,600.00
Henry Blase (Dollar General)	1110 Marshall Ave., Chapman, Kansas	\$ 20,000.00	\$ 911,370.00	\$ 931,370.00
KCML Holdings, LLC (DK Fitness)	1030 Marshall Ave., Chapman, Kansas	\$ 20,000.00	\$ 762,320.00	\$ 782,320.00
City of Chapman	2000 Blk, 2650 Ave., Chapman, Kansas	\$ 122,900.00	\$ -	\$ 122,900.00
Casey's Retail Company	1002 Marshall Ave., Chapman, Kansas	\$ 32,500.00	\$ 390,250.00	\$ 422,750.00
KIDDCO, LLC	910 Marshall Ave., Chapman, Kansas	\$ 21,650.00	\$ 198,240.00	\$ 219,890.00
Joe Stalder	202 E. 4th St., Chapman, Kansas	\$ 5,400.00	\$ 51,070.00	\$ 56,470.00
Allison Lewis	218 E. 4th St., Chapman, Kansas	\$ 4,500.00	\$ -	\$ 4,500.00
Charlie Meyer	222 E. 4th St., Chapman, Kansas	\$ 2,500.00	\$ 11,400.00	\$ 13,900.00
David Whitley	200 Blk, E. 4th St., Chapman, Kansas	\$ 1,200.00	\$ 1,040.00	\$ 2,240.00
Diane Thomas	230 E. 4th St., Chapman, Kansas	\$ 5,000.00	\$ 38,150.00	\$ 43,150.00
Michael Henkel	238 E. 4th St., Chapman, Kansas	\$ 8,750.00	\$ 72,680.00	\$ 81,430.00
Charlie Meyer	302 E. 4th St., Chapman, Kansas	\$ 52,940.00	\$ 10,960.00	\$ 63,900.00
Unified School District #473	320 E. 4th St., Chapman, Kansas	\$ 67,000.00	\$ 61,470.00	\$ 128,470.00
City of Chapman	2000 Blk, Old Hwy 40, Chapman, Kansas	\$ 3,100.00	\$ -	\$ 3,100.00

Central Business District (B-5)				
Name	Address	Lot Value	Improvements	Total
Emmely, LLC (Post Office)	102 E. 5th St., Chapman, Kansas	\$ 3,900.00	\$ 56,830.00	\$ 60,730.00
City of Chapman	102 E. 5th St., Chapman, Kansas	\$ 18,000.00	\$ 7,030.00	\$ 25,030.00
Michael McGarvey	114 E. 5th St., Chapman, Kansas	\$ 5,000.00	\$ 77,650.00	\$ 82,650.00
Maria Del Refugio Soria Martinez	120 E. 5th St., Chapman, Kansas	\$ 10,000.00	\$ 74,820.00	\$ 84,820.00
Londeen's Hardware, LLC	445 Marshall Ave., Chapman, Kansas	\$ 9,540.00	\$ 155,540.00	\$ 165,080.00
Zachary Lucas (4:10 Irish Den)	437 Marshall Ave., Chapman, Kansas	\$ 1,990.00	\$ 59,000.00	\$ 60,990.00
Harold Oakleaf Family Trust	433 Marshall Ave., Chapman, Kansas	\$ 2,640.00	\$ 24,540.00	\$ 27,180.00
Chapman Senior Center, Inc.	429 Marshall Ave., Chapman, Kansas	\$ 13,200.00	\$ 40,000.00	\$ 53,200.00
Jeremiah Woods	425 Marshall Ave., Chapman, Kansas	\$ 3,380.00	\$ 38,390.00	\$ 41,770.00
Cynthia Hutchinson (High Maintenance Salon)	421 Marshall Ave., Chapman, Kansas	\$ 5,530.00	\$ 88,980.00	\$ 94,510.00
Wei Cang Xie (Hong Kong Fresh)	417 Marshall Ave., Chapman, Kansas	\$ 11,460.00	\$ 59,250.00	\$ 70,710.00
City of Chapman (Fitness Center)	413 Marshall Ave., Chapman, Kansas	\$ 15,070.00	\$ 59,790.00	\$ 74,860.00
Hamilton Homesteads, LLC.	409 Marshall Ave., Chapman, Kansas	\$ 7,480.00	\$ 9,730.00	\$ 17,210.00
Tana Churan-Davis	401 Marshall Ave., Chapman, Kansas	\$ 5,260.00	\$ 73,850.00	\$ 79,110.00
Donna Shepard	114 W. 4th St., Chapman, Kansas	\$ 2,810.00	\$ 62,720.00	\$ 65,530.00
Dean and Marilyn Zellers Trust	122 W. 4th St., Chapman, Kansas	\$ 3,750.00	\$ 80.00	\$ 3,830.00
Salvator Lanfranca	126 W. 4th St., Chapman, Kansas	\$ 11,540.00	\$ 21,940.00	\$ 33,480.00
WCCRT, LLC (Aid Station Pizza)	138 W. 4th St., Chapman, Kansas	\$ 9,880.00	\$ 8,510.00	\$ 18,390.00
City of Chapman (City Hall)	446 Marshall Ave., Chapman, Kansas	\$ 6,720.00	\$ 128,260.00	\$ 134,980.00
Chapman Area Preservation Society	442 Marshall Ave., Chapman, Kansas	\$ 2,040.00	\$ 17,410.00	\$ 19,450.00
Ashley Prosser (Kansas Coffee & Ice Cream)	428 Marshall Ave., Chapman, Kansas	\$ 3,460.00	\$ 42,590.00	\$ 46,050.00
Brian Gaston	424 Marshall Ave., Chapman, Kansas	\$ 4,260.00	\$ 30,000.00	\$ 34,260.00
Rick Johnson (Kim's Daycare)	406 Marshall Ave., Chapman, Kansas	\$ 3,380.00	\$ 52,650.00	\$ 56,030.00
City of Chapman (Library / Fire Dept)	402 Marshall Ave., Chapman, Kansas	\$ 8,390.00	\$ 94,750.00	\$ 103,140.00
Rick Johnson	112 E. 4th St., Chapman, Kansas	\$ 15,000.00	\$ -	\$ 15,000.00
Brandon Hurt (Grandma's House/1855 Liquor)	114 E. 4th St., Chapman, Kansas	\$ 3,040.00	\$ 33,020.00	\$ 36,060.00

Southwestern Bell Telephone Company	116 E. 4th St., Chapman, Kansas	\$	6,250.00	\$	23,700.00	\$	29,950.00
Tri-County Telephone Association, LLC	120 E. 4th St., Chapman, Kansas	\$	4,380.00	\$	-	\$	4,380.00
City of Chapman	100 Blk. E. 4th St., Chapman, Kansas	\$	33,750.00	\$	-	\$	33,750.00
Joe Stalder	0000 E. 4th St., Chapman, Kansas	\$	4,870.00	\$	-	\$	4,870.00
Emmely, LLC (Clinic)	111 E. 5th St., Chapman, Kansas	\$	2,600.00	\$	53,720.00	\$	56,320.00
Gary Oesterhaus	117 W. 3rd St., Chapman, Kansas	\$	5,760.00	\$	470.00	\$	6,230.00
Dennis Will	115 W. 3rd St., Chapman, Kansas	\$	4,760.00	\$	8,960.00	\$	13,720.00
Laeth Bender	113 W. 3rd St., Chapman, Kansas	\$	9,410.00	\$	9,230.00	\$	18,640.00
Laeth Bender	111 W. 3rd St., Chapman, Kansas	\$	2,250.00	\$	-	\$	2,250.00
Agri Trails Coop, Inc.	106 W. 3rd St., Chapman, Kansas	\$	3,320.00	\$	-	\$	3,320.00
Lawrence Brunswick American Legion	222 Marshall Ave., Chapman, Kansas	\$	7,670.00	\$	55,610.00	\$	63,280.00
City of Chapman (Old Grocery Store)	105 E. 3rd St., Chapman, Kansas	\$	15,150.00	\$	7,070.00	\$	22,220.00
Krinhop Family Trust	109 E. 3rd St., Chapman, Kansas	\$	5,540.00	\$	9,530.00	\$	15,070.00
Swede Swenson	109B E. 3rd St., Chapman, Kansas	\$	4,430.00	\$	7,560.00	\$	11,990.00
Grace Baptist Church	113 E. 3rd St., Chapman, Kansas	\$	12,330.00	\$	-	\$	12,330.00
Grace Baptist Church	117 E. 3rd St., Chapman, Kansas	\$	12,760.00	\$	62,850.00	\$	75,610.00
Joe Stalder	129 E. 3rd St., Chapman, Kansas	\$	21,370.00	\$	31,620.00	\$	52,990.00
Jeffrey Wenger	131 E. 3rd St., Chapman, Kansas	\$	6,270.00	\$	19,050.00	\$	25,320.00
City of Chapman (Maintenance Shop)	221 Anderson Ave., Chapman, Kansas	\$	22,600.00	\$	24,000.00	\$	46,600.00

South Residential District (R-3)		Lot Value		Improvements		Total	
Name	Address						
Diane Thomas	100 Blk. E. 1st St., Chapman, Kansas	\$	3,440.00	\$	-	\$	3,440.00
Christopher Werner	101 Anderson Ave, Chapman, Kansas	\$	15,680.00	\$	134,500.00	\$	150,180.00
Stanley Arveson	0000 E. 1st St, Chapman, Kansas	\$	32,020.00	\$	14,420.00	\$	46,440.00
Stanley Arveson	121 E. 1st St., Chapman, Kansas	\$	6,360.00	\$	87,490.00	\$	93,850.00
Stanley Arveson	129 E. 1st St., Chapman, Kansas	\$	15,950.00	\$	13,020.00	\$	28,970.00
Meagan Schlappy	205 E. 1st St., Chapman, Kansas	\$	11,500.00	\$	29,990.00	\$	41,490.00

James Cordin	209 E. 1st St., Chapman, Kansas	\$	25,390.00	\$	96,990.00	\$	122,380.00
Len Bender	213 E. 1st St., Chapman, Kansas	\$	13,750.00	\$	5,630.00	\$	19,380.00
Len Bender	217 E. 1st St., Chapman, Kansas	\$	13,850.00	\$	99,080.00	\$	112,930.00
Harold Oakleaf	221 E. 1st St., Chapman, Kansas	\$	13,330.00	\$	30,910.00	\$	44,240.00
Lance Bender	0000 E. 1st St., Chapman, Kansas	\$	19,560.00	\$	-	\$	19,560.00
Gary Williams	233 E. 1st St., Chapman, Kansas	\$	4,000.00	\$	13,870.00	\$	17,870.00
Sean Fink	237 E. 1st St., Chapman, Kansas	\$	11,480.00	\$	38,130.00	\$	49,610.00
Randy Gingrich	301 E. 1st St., Chapman, Kansas	\$	32,940.00	\$	147,190.00	\$	180,130.00
Michael Meldon	109 Anderson Ave., Chapman, Kansas	\$	4,070.00	\$	64,430.00	\$	68,500.00
Clifford Hutchinson	102 Anderson Ave, Chapman, Kansas	\$	8,500.00	\$	51,500.00	\$	60,000.00
Ian Williams	110 Anderson Ave., Chapman, Kansas	\$	8,500.00	\$	72,710.00	\$	81,210.00
Bryce Marshall	210 E. 1st St., Chapman, Kansas	\$	13,000.00	\$	72,830.00	\$	85,830.00
Shane Ashby	216 E. 1st St., Chapman, Kansas	\$	17,500.00	\$	43,420.00	\$	60,920.00
Karen Hendrix	222 E. 1st St., Chapman, Kansas	\$	10,000.00	\$	52,290.00	\$	62,290.00
Lane Bender	226 E. 1st St., Chapman, Kansas	\$	17,500.00	\$	80,020.00	\$	97,520.00
Dana Gaither	232 E. 1st St., Chapman, Kansas	\$	10,000.00	\$	450.00	\$	10,450.00
Dana Gaither	115 Noble Ave., Chapman, Kansas	\$	10,000.00	\$	-	\$	10,000.00
Debra Pelfrey	102 Noble Ave., Chapman, Kansas	\$	5,970.00	\$	9,800.00	\$	15,770.00
Debra Pelfrey	302 E. 1st St., Chapman, Kansas	\$	6,050.00	\$	120,830.00	\$	126,880.00
Opal Dalton	110 Noble Ave., Chapman, Kansas	\$	13,930.00	\$	56,800.00	\$	70,730.00
James Murrison	101 E. 2nd St., Chapman, Kansas	\$	13,000.00	\$	60,540.00	\$	73,540.00
Shane Fisher	105 E. 2nd St., Chapman, Kansas	\$	7,250.00	\$	95,440.00	\$	102,690.00
John Childs	107 E. 2nd St., Chapman, Kansas	\$	4,250.00	\$	57,330.00	\$	61,580.00
Lea Hand	117 E. 2nd St., Chapman, Kansas	\$	5,750.00	\$	55,530.00	\$	61,280.00
James McCarrell	127 E. 2nd St., Chapman, Kansas	\$	8,750.00	\$	81,030.00	\$	89,780.00
Diane Thomas	129 E. 2nd St., Chapman, Kansas	\$	8,750.00	\$	98,120.00	\$	106,870.00
Ian Fitzgerald	121 Anderson Ave., Chapman, Kansas	\$	5,000.00	\$	87,800.00	\$	92,800.00
Jacob Lantz	201 E. 2nd St., Chapman, Kansas	\$	10,750.00	\$	15,710.00	\$	26,460.00
Jody Mataruso	205 E. 2nd St., Chapman, Kansas	\$	6,010.00	\$	6,780.00	\$	12,790.00

Adam Baker	209 E. 2nd St., Chapman, Kansas	\$ 11,500.00	\$ 73,240.00	\$ 84,740.00
Steven Manning	217 E. 2nd St., Chapman, Kansas	\$ 16,000.00	\$ 87,690.00	\$ 103,690.00
Brian Loy	221 E. 2nd St., Chapman, Kansas	\$ 17,500.00	\$ 16,280.00	\$ 33,780.00
Glen Whitley	229 E. 2nd St., Chapman, Kansas	\$ 10,000.00	\$ 54,890.00	\$ 64,890.00
Rachel Owen	237 E. 2nd St., Chapman, Kansas	\$ 17,500.00	\$ 57,250.00	\$ 74,750.00
Chris Holliman	118 Noble Ave., Chapman, Kansas	\$ 14,700.00	\$ 13,140.00	\$ 27,840.00
Chris Holliman	122 Noble Ave., Chapman, Kansas	\$ 8,150.00	\$ 37,050.00	\$ 45,200.00
Michael LeMaster	313 E. 2nd St., Chapman, Kansas	\$ 14,990.00	\$ 151,120.00	\$ 166,110.00
Harold Oakleaf	318 E. 2nd St., Chapman, Kansas	\$ 13,360.00	\$ 37,370.00	\$ 50,730.00
Harold Oakleaf	202 Noble Ave., Chapman, Kansas	\$ 8,860.00	\$ 25,580.00	\$ 34,440.00
Laeth Bender	201 Noble Ave., Chapman, Kansas	\$ 8,800.00	\$ 95,190.00	\$ 103,990.00
Ted Cable	230 E. 2nd St., Chapman, Kansas	\$ 13,830.00	\$ 52,700.00	\$ 66,530.00
McRae Holdings, LLC	222 E. 2nd St., Chapman, Kansas	\$ 13,820.00	\$ 31,670.00	\$ 45,490.00
Joseph Fisher	214 E. 2nd St., Chapman, Kansas	\$ 17,600.00	\$ 70,410.00	\$ 88,010.00
Womochil Properties, LLC	210 E. 2nd St., Chapman, Kansas	\$ 10,050.00	\$ 21,210.00	\$ 31,260.00
Gary Kolling	202 Anderson Ave., Chapman, Kansas	\$ 17,600.00	\$ 37,890.00	\$ 55,490.00
Steve Knox	138 E. 2nd St., Chapman, Kansas	\$ 7,540.00	\$ 30,880.00	\$ 38,420.00
James Gutierrez	136 E. 2nd St., Chapman, Kansas	\$ 10,050.00	\$ 84,300.00	\$ 94,350.00
Jeffrey Wenger	134 E. 2nd St., Chapman, Kansas	\$ 10,050.00	\$ 34,870.00	\$ 44,920.00
Leon Morton	128 E. 2nd St., Chapman, Kansas	\$ 5,020.00	\$ 23,810.00	\$ 28,830.00
Sara McCarrell	122 E. 2nd St., Chapman, Kansas	\$ 10,050.00	\$ 50,820.00	\$ 60,870.00
Kevin Crawley	118 E. 2nd St., Chapman, Kansas	\$ 5,030.00	\$ 27,970.00	\$ 33,000.00
Cherlindrea Adolph	114 E. 2nd St., Chapman, Kansas	\$ 10,650.00	\$ 94,360.00	\$ 105,010.00
Gregory McLaughlin	110 E. 2nd St., Chapman, Kansas	\$ 9,450.00	\$ 50,230.00	\$ 59,680.00
Gary Kolling	102 E. 2nd St., Chapman, Kansas	\$ 8,800.00	\$ 53,000.00	\$ 61,800.00
City of Chapman	201 E. 3rd St., Chapman, Kansas	\$ 17,600.00	\$ 70,320.00	\$ 87,920.00
Kenneth Fahey	00000 E. 3rd St., Chapman, Kansas	\$ 12,320.00	-	\$ 12,320.00
Steven Wichersham	217 E. 3rd St., Chapman, Kansas	\$ 10,050.00	\$ 50,750.00	\$ 60,800.00
Edward Wehrmeister	225 E. 3rd St., Chapman, Kansas	\$ 7,920.00	\$ 17,470.00	\$ 25,390.00

Edward Wehrmeister	231 E. 3rd St., Chapman, Kansas	\$ 13,830.00	\$ 65,590.00	\$ 79,420.00
Patricia McMillan	237 E. 3rd St., Chapman, Kansas	\$ 13,820.00	\$ 39,500.00	\$ 53,320.00
Wayne Frasure	222 Noble Ave., Chapman, Kansas	\$ 6,690.00	\$ 55,260.00	\$ 61,950.00
Calvin Morrell	218 Noble Ave., Chapman, Kansas	\$ 9,750.00	\$ 29,750.00	\$ 39,500.00
Leonard Arveson	209 Marshall Ave., Chapman, Kansas	\$ 6,260.00	\$ 65,280.00	\$ 71,540.00
James Taylor	201 Marshall Ave., Chapman, Kansas	\$ 26,800.00	\$ 126,540.00	\$ 153,340.00
Lynn Battishill	100 Blk Marshall Ave., Chapman, Kansas	\$ 9,280.00	\$ 600.00	\$ 9,880.00

Northeast Residential District (R-3)				
Name	Address	Lot Value	Improvements	Total
David Manning	125 E. 5th St., Chapman, Kansas	\$ 8,750.00	\$ 106,670.00	\$ 115,420.00
Michael McGarvey	129 E. 5th St., Chapman, Kansas	\$ 10,000.00	\$ 36,920.00	\$ 46,920.00
Gregory McLaughlin	413 Anderson Ave., Chapman, Kansas	\$ 5,000.00	\$ 45,720.00	\$ 50,720.00
Patricia Stout	137 E. 5th St., Chapman, Kansas	\$ 10,000.00	\$ 68,100.00	\$ 78,100.00
Shawn Marshall	420 Anderson Ave., Chapman, Kansas	\$ 10,000.00	\$ 17,210.00	\$ 27,210.00
Paul Kornberger	211 E. 5th St., Chapman, Kansas	\$ 12,500.00	\$ 122,420.00	\$ 134,920.00
Gregory McLaughlin	217 E. 5th St., Chapman, Kansas	\$ 5,000.00	\$ 44,530.00	\$ 49,530.00
Franklin Prescher	221 E. 5th St., Chapman, Kansas	\$ 5,000.00	\$ 47,400.00	\$ 52,400.00
David Whitley	225 E. 5th St., Chapman, Kansas	\$ 5,000.00	\$ 50,120.00	\$ 55,120.00
Jordon Whitson	421 Noble Ave., Chapman, Kansas	\$ 25,000.00	\$ 89,310.00	\$ 114,310.00
Zachary Lucas	422 Noble Ave., Chapman, Kansas	\$ 14,230.00	\$ 110,930.00	\$ 125,160.00
Duncan Spangler	302 E. 5th St., Chapman, Kansas	\$ 13,070.00	\$ 31,840.00	\$ 44,910.00
Jeanene Marshall	238 E. 5th St., Chapman, Kansas	\$ 8,750.00	\$ 30,950.00	\$ 39,700.00
William Mason	228 E. 5th St., Chapman, Kansas	\$ 10,000.00	\$ 51,140.00	\$ 61,140.00
David Donmyer	226 E. 5th St., Chapman, Kansas	\$ 8,750.00	\$ 91,410.00	\$ 100,160.00
Battle Summerville	218 E. 5th St., Chapman, Kansas	\$ 5,000.00	\$ 85,020.00	\$ 90,020.00
Neal Wheatley	214 E. 5th St., Chapman, Kansas	\$ 5,000.00	\$ -	\$ 5,000.00
Carolyn Christensen	502 Anderson Ave., Chapman, Kansas	\$ 12,500.00	\$ 151,540.00	\$ 164,040.00

James Becquart	138 E. 5th St., Chapman, Kansas	\$ 13,750.00	\$ 18,540.00	\$ 32,290.00
Michael Ade	130 E. 5th St., Chapman, Kansas	\$ 8,750.00	\$ -	\$ 8,750.00
Harold Bray	122 E. 5th St., Chapman, Kansas	\$ 13,750.00	\$ 55,370.00	\$ 69,120.00
Douglas Londene	101 E. 6th St., Chapman, Kansas	\$ 8,750.00	\$ 122,920.00	\$ 131,670.00
Merle Brown	109 E. 6th St., Chapman, Kansas	\$ 5,000.00	\$ 73,080.00	\$ 78,080.00
Stacey Rucker	117 E. 6th St., Chapman, Kansas	\$ 17,500.00	\$ 76,120.00	\$ 93,620.00
Harold Oakleaf	121 E. 6th St., Chapman, Kansas	\$ 5,000.00	\$ 29,870.00	\$ 34,870.00
Elizabeth Rodriguez	127 E. 6th St., Chapman, Kansas	\$ 10,630.00	\$ 144,190.00	\$ 154,820.00
Gregory McLaughlin	137 E. 6th St., Chapman, Kansas	\$ 6,190.00	\$ 51,830.00	\$ 58,020.00
Damon Helmig	526 Anderson Ave., Chapman, Kansas	\$ 5,000.00	\$ 88,800.00	\$ 93,800.00
Gregory McLaughlin	211 E. 6th St., Chapman, Kansas	\$ 17,500.00	\$ 18,010.00	\$ 35,510.00
Harold Oakleaf	213 E. 6th St., Chapman, Kansas	\$ 8,750.00	\$ 43,050.00	\$ 51,800.00
Michael Ade	226 E. 6th St., Chapman, Kansas	\$ 3,440.00	\$ 12,940.00	\$ 16,380.00
Gregory McLaughlin	229 E. 6th St., Chapman, Kansas	\$ 6,870.00	\$ 49,010.00	\$ 55,880.00
David Hertzog	237 E. 6th St., Chapman, Kansas	\$ 10,500.00	\$ 170,070.00	\$ 180,570.00
Christopher Harding	514 Noble Ave., Chapman, Kansas	\$ 8,100.00	\$ 107,340.00	\$ 115,440.00
Cole Krinhop	522 Noble Ave., Chapman, Kansas	\$ 7,970.00	\$ 117,850.00	\$ 125,820.00
Gregory McLaughlin	606 Noble Ave., Chapman, Kansas	\$ 12,360.00	\$ 62,240.00	\$ 74,600.00
Christina Welsh	616 Noble Ave., Chapman, Kansas	\$ 9,250.00	\$ 31,440.00	\$ 40,690.00
St. Michael's Church	210 E. 6th St., Chapman, Kansas	\$ 48,700.00	\$ 1,476,040.00	\$ 1,524,740.00
Leon Morton	138 E. 6th St., Chapman, Kansas	\$ 6,440.00	\$ 90,860.00	\$ 97,300.00
Gregory McLaughlin	132 E. 6th St., Chapman, Kansas	\$ 8,470.00	\$ 77,980.00	\$ 86,450.00
Braydan Ash	130 E. 6th St., Chapman, Kansas	\$ 15,810.00	\$ 162,190.00	\$ 178,000.00
Natalie Bird	122 E. 6th St., Chapman, Kansas	\$ 7,860.00	\$ 101,870.00	\$ 109,730.00
Dick Demary	118 E. 6th St., Chapman, Kansas	\$ 8,790.00	\$ 77,390.00	\$ 86,180.00
Debra Morren	110 E. 6th St., Chapman, Kansas	\$ 8,730.00	\$ 99,250.00	\$ 107,980.00
John Oxford	102 E. 6th St., Chapman, Kansas	\$ 6,900.00	\$ 172,730.00	\$ 179,630.00
John Oxford	614 Marshall Ave., Chapman, Kansas	\$ 10,950.00	\$ -	\$ 10,950.00
David Alsop	824 Marshall Ave., Chapman, Kansas	\$ 12,410.00	\$ 193,740.00	\$ 206,150.00

Christal Baker	109 E. 9th St., Chapman, Kansas	\$ 6,830.00	\$ 134,230.00	\$ 141,060.00
Joseph Stroud	902 Marshall Ave., Chapman, Kansas	\$ 7,330.00	\$ 125,940.00	\$ 133,270.00
Mary McDonald	106 E. 9th St., Chapman, Kansas	\$ 7,330.00	\$ 126,040.00	\$ 133,370.00
Kathleen Chamberlin	110 E. 9th St., Chapman, Kansas	\$ 7,330.00	\$ 123,670.00	\$ 131,000.00

Northwest Residential District (R-3)				
Name	Address	Lot Value	Improvements	Total
Marilyn Weishaar	00000 Manor Dr., Chapman, Kansas	\$ 12,960.00	\$ -	\$ 12,960.00
Marilyn Weishaar	1009 Manor Dr., Chapman, Kansas	\$ 12,970.00	\$ 124,550.00	\$ 137,520.00
Darlene Stillwagon	1005 Manor Dr., Chapman, Kansas	\$ 12,990.00	\$ 156,240.00	\$ 169,230.00
Genevieve Arveson	1001 Manor Dr., Chapman, Kansas	\$ 13,000.00	\$ 144,940.00	\$ 157,940.00
James Carroll	939 Marshall Ave., Chapman, Kansas	\$ 27,480.00	\$ 138,470.00	\$ 165,950.00
Leland Bauman	201 Kimberly Ave., Chapman, Kansas	\$ 25,050.00	\$ 238,920.00	\$ 263,970.00
Daryl Beemer	205 Kimberly Ave., Chapman, Kansas	\$ 36,260.00	\$ 249,170.00	\$ 285,430.00
Michael Rowley	301 Kimberly Ave., Chapman, Kansas	\$ 14,000.00	\$ 171,060.00	\$ 185,060.00
Daryl Beemer	305 Kimberly Ave., Chapman, Kansas	\$ 13,660.00	\$ 157,300.00	\$ 170,960.00
Dustin Heller	309 Kimberly Ave., Chapman, Kansas	\$ 14,330.00	\$ 159,040.00	\$ 173,370.00
Richard Chambers	315 Kimberly Ave., Chapman, Kansas	\$ 13,330.00	\$ 153,910.00	\$ 167,240.00
Ronald McGinnis	917 Marshall Ave., Chapman, Kansas	\$ 29,240.00	\$ 123,040.00	\$ 152,280.00
Ronald McGinnis	114 W. 9th St., Chapman, Kansas	\$ 8,200.00	\$ 115,130.00	\$ 123,330.00
Ariana Adams	126 W. 9th St., Chapman, Kansas	\$ 9,000.00	\$ 109,040.00	\$ 118,040.00
Elizabeth Sites	132 W. 9th St., Chapman, Kansas	\$ 16,810.00	\$ 170,080.00	\$ 186,890.00
Bill Flanery	146 W. 9th St., Chapman, Kansas	\$ 13,620.00	\$ 121,050.00	\$ 134,670.00
Harvey Moritz	206 W. 9th St., Chapman, Kansas	\$ 44,580.00	\$ 181,280.00	\$ 225,860.00
Harvey Moritz	00000 W. 9th St., Chapman, Kansas	\$ 1,410.00	\$ 1,780.00	\$ 3,190.00
Zephyr Tate-Mann	222 W. 9th St., Chapman, Kansas	\$ 23,500.00	\$ 256,500.00	\$ 280,000.00
Trevor Smith	238 W. 9th St., Chapman, Kansas	\$ 23,350.00	\$ 223,240.00	\$ 246,590.00
Michael Scaletty	300 W. 9th St., Chapman, Kansas	\$ 7,260.00	\$ 221,080.00	\$ 228,340.00

Nathan Garrison	320 W. 9th St., Chapman, Kansas	\$	8,300.00	\$	117,910.00	\$	126,210.00
Ava Leake	330 W. 9th St., Chapman, Kansas	\$	7,270.00	\$	125,730.00	\$	133,000.00
Collin Sullivan	402 W. 9th St., Chapman, Kansas	\$	11,000.00	\$	202,000.00	\$	213,000.00
Julie Vogelsand-Switzer	416 W. 9th St., Chapman, Kansas	\$	7,150.00	\$	134,610.00	\$	141,760.00
Karen Deise-Poff	438 W. 9th St., Chapman, Kansas	\$	29,370.00	\$	96,070.00	\$	125,440.00
Shawn Howard	901 Logan Ave., Chapman, Kansas	\$	36,910.00	\$	87,110.00	\$	124,020.00
Raymond Corbett	913 Logan Ave., Chapman, Kansas	\$	13,230.00	\$	132,050.00	\$	145,280.00
Ricky Erickson	516 Logan Terrace, Chapman, Kansas	\$	13,230.00	\$	154,410.00	\$	167,640.00
Drew Gruver	506 W. 9th St., Chapman, Kansas	\$	16,360.00	\$	209,570.00	\$	225,930.00
Nicole Poff	508 W. 9th St., Chapman, Kansas	\$	22,310.00	\$	239,340.00	\$	261,650.00
Adam Mahan	520 W. 9th St., Chapman, Kansas	\$	13,700.00	\$	332,020.00	\$	345,720.00
Hilda Livingston	513 W. 9th St., Chapman, Kansas	\$	11,180.00	\$	278,980.00	\$	290,160.00
Kristina Ostermeyer	511 W. 9th St., Chapman, Kansas	\$	19,400.00	\$	242,600.00	\$	262,000.00
James Bell	509 W. 9th St., Chapman, Kansas	\$	10,780.00	\$	198,090.00	\$	208,870.00
John Childs	507 W. 9th St., Chapman, Kansas	\$	18,660.00	\$	173,340.00	\$	192,000.00
Jeremy Sholtz	829 Logan Ave., Chapman, Kansas	\$	20,960.00	\$	96,980.00	\$	117,940.00
Bryce Forth	821 Logan Ave., Chapman, Kansas	\$	18,680.00	\$	176,840.00	\$	195,520.00
John Harris	435 W. 9th St., Chapman, Kansas	\$	20,620.00	\$	138,580.00	\$	159,200.00
Rudolph Peterle	818 Logan Ave., Chapman, Kansas	\$	14,610.00	\$	135,820.00	\$	150,430.00
Stephen Fansler	400 Block W. 9th St., Chapman, Kansas	\$	2,990.00	\$	-	\$	2,990.00
Stephen Fansler	829 Broadway Ave., Chapman, Kansas	\$	5,500.00	\$	27,040.00	\$	32,540.00
Mary Moreland	817 Broadway Ave., Chapman, Kansas	\$	16,100.00	\$	66,450.00	\$	82,550.00
Justin Jury	329 W. 9th St., Chapman, Kansas	\$	8,490.00	\$	62,070.00	\$	70,560.00
David John	820 Broadway Ave., Chapman, Kansas	\$	8,500.00	\$	115,180.00	\$	123,680.00
Brian Sedoris	327 W. 9th St., Chapman, Kansas	\$	14,490.00	\$	170,720.00	\$	185,210.00
Raymond Arveson	829 Glick Ave., Chapman, Kansas	\$	24,980.00	\$	70,110.00	\$	95,090.00
Dale Nelson	225 W. 9th St., Chapman, Kansas	\$	13,430.00	\$	162,410.00	\$	175,840.00
Betty Ryan	822 Glick Ave., Chapman, Kansas	\$	6,330.00	\$	107,840.00	\$	114,170.00
William Porch	141 W. 9th St., Chapman, Kansas	\$	10,880.00	\$	89,130.00	\$	100,010.00

Lonnie Halsey	833 Sheeran Ave., Chapman, Kansas	\$ 12,100.00	\$ 127,150.00	\$ 139,250.00
Lonnie Halsey	100 Block W. 9th St., Chapman, Kansas	\$ 7,980.00	\$ -	\$ 7,980.00
Ronald McGinnis	121 W. 9th St., Chapman, Kansas	\$ 3,620.00	\$ 14,260.00	\$ 17,880.00
Deborah Dousharm	100 Block W. 9th St., Chapman, Kansas	\$ 3,690.00	\$ -	\$ 3,690.00
Deborah Dousharm	825 Marshall Ave., Chapman, Kansas	\$ 5,730.00	\$ 71,860.00	\$ 77,590.00
Frieze Rentals	100 Block W. 9th St., Chapman, Kansas	\$ 2,180.00	\$ 2,280.00	\$ 4,460.00
Joshua Marshall	817 Marshall Ave., Chapman, Kansas	\$ 6,360.00	\$ 96,840.00	\$ 103,200.00
John Beavors	815 Marshall Ave., Chapman, Kansas	\$ 4,950.00	\$ 52,890.00	\$ 57,840.00
Brady Reed Realty	106 W. 8th St., Chapman, Kansas	\$ 7,970.00	\$ 137,900.00	\$ 145,870.00
Darrin Gaither	108 W. 8th St., Chapman, Kansas	\$ 15,230.00	\$ 175,050.00	\$ 190,280.00
James McGuire	138 W. 8th St., Chapman, Kansas	\$ 5,790.00	\$ 9,250.00	\$ 15,040.00
Mark Cagle	146 W. 8th St., Chapman, Kansas	\$ 7,240.00	\$ 78,870.00	\$ 86,110.00
Herbert Graves	214 W. 8th St., Chapman, Kansas	\$ 8,200.00	\$ 189,910.00	\$ 198,110.00
Lynn Heath	222 W. 8th St., Chapman, Kansas	\$ 8,500.00	\$ 57,690.00	\$ 66,190.00
Eli Stewart	226 W. 8th St., Chapman, Kansas	\$ 8,500.00	\$ 101,860.00	\$ 110,360.00
Dalton Millican	230 W. 8th St., Chapman, Kansas	\$ 8,500.00	\$ 77,590.00	\$ 86,090.00
Charles Horner	823 Glick Ave., Chapman, Kansas	\$ 17,510.00	\$ 123,340.00	\$ 140,850.00
Elizabeth Boltz-Morton	318 W. 8th St., Chapman, Kansas	\$ 22,640.00	\$ 141,570.00	\$ 164,210.00
Bruce West	326 W. 8th St., Chapman, Kansas	\$ 13,800.00	\$ 119,240.00	\$ 133,040.00
Carmen Alvarez	801 Broadway Ave., Chapman, Kansas	\$ 18,900.00	\$ 74,280.00	\$ 93,180.00
Jason Marshall	414 W. 8th St., Chapman, Kansas	\$ 6,940.00	\$ 74,600.00	\$ 81,540.00
Janice Warhurst	422 W. 8th St., Chapman, Kansas	\$ 11,570.00	\$ 96,420.00	\$ 107,990.00
Christopher Johnson	438 W. 8th St., Chapman, Kansas	\$ 13,340.00	\$ 270,410.00	\$ 283,750.00
Richard Jansen	805 Logan Ave., Chapman, Kansas	\$ 17,540.00	\$ 120,850.00	\$ 138,390.00
Jerry Spencer	518 W. 8th St., Chapman, Kansas	\$ 19,940.00	\$ 63,960.00	\$ 83,900.00
Joseph Audy	522 W. 8th St., Chapman, Kansas	\$ 21,760.00	\$ 157,160.00	\$ 178,920.00
Ryan Williams	526 W. 8th St., Chapman, Kansas	\$ 18,500.00	\$ 169,120.00	\$ 187,620.00
John Gasswint	530 W. 8th St., Chapman, Kansas	\$ 11,690.00	\$ 126,290.00	\$ 137,980.00
Krista Clark-Mendiola	534 W. 8th St., Chapman, Kansas	\$ 18,080.00	\$ 140,890.00	\$ 158,970.00

Michael Spohn	538 W. 8th St., Chapman, Kansas	\$ 21,100.00	\$ 176,110.00	\$ 197,210.00
Ryan Rogowski	733 Hillside Dr., Chapman, Kansas	\$ 21,060.00	\$ 190,100.00	\$ 211,160.00
ASLAC Properties	721 Hillside Dr., Chapman, Kansas	\$ 13,790.00	\$ 181,180.00	\$ 194,970.00
Michael Mann	713 Hillside Dr., Chapman, Kansas	\$ 9,410.00	\$ 75,440.00	\$ 84,850.00
Thomas Kim	614 W. 7th St., Chapman, Kansas	\$ 10,560.00	\$ 134,530.00	\$ 145,090.00
Michael Lowrey	608 W. 7th St., Chapman, Kansas	\$ 10,050.00	\$ 113,530.00	\$ 123,580.00
Jason Huss	602 W. 7th St., Chapman, Kansas	\$ 9,240.00	\$ 147,740.00	\$ 156,980.00
James Frohardt	702 Hillside Dr., Chapman, Kansas	\$ 10,160.00	\$ 81,470.00	\$ 91,630.00
Rose Lindsey	712 Hillside Dr., Chapman, Kansas	\$ 12,330.00	\$ 115,980.00	\$ 128,310.00
Rose Aguirre	722 Hillside Dr., Chapman, Kansas	\$ 13,720.00	\$ 122,960.00	\$ 136,680.00
Corey McCurdy	537 W. 8th St., Chapman, Kansas	\$ 13,690.00	\$ 119,420.00	\$ 133,110.00
Feliza Contreras	533 W. 8th St., Chapman, Kansas	\$ 14,160.00	\$ 131,930.00	\$ 146,090.00
Ronnie Bellomy	529 W. 8th St., Chapman, Kansas	\$ 14,370.00	\$ 113,210.00	\$ 127,580.00
James McGuire	525 W. 8th St., Chapman, Kansas	\$ 19,300.00	\$ 40,700.00	\$ 60,000.00
Wesley Phillips	513 W. 8th St., Chapman, Kansas	\$ 10,080.00	\$ 102,160.00	\$ 112,240.00
Andrew Campbell	505 W. 8th St., Chapman, Kansas	\$ 10,130.00	\$ 151,630.00	\$ 161,760.00
Gabriel Navarrette	725 Logan Ave., Chapman, Kansas	\$ 19,240.00	\$ 156,140.00	\$ 175,380.00
Lynn Battishill	437 W. 8th St., Chapman, Kansas	\$ 8,510.00	\$ 68,220.00	\$ 76,730.00
Roberta Thurlow	724 Logan Ave., Chapman, Kansas	\$ 8,520.00	\$ 50,870.00	\$ 59,390.00
Mark Sekulich	429 W. 8th St., Chapman, Kansas	\$ 5,810.00	\$ 105,370.00	\$ 111,180.00
Ricky Haynes	425 W. 8th St., Chapman, Kansas	\$ 11,520.00	\$ 66,650.00	\$ 78,170.00
Daniel Quiring	417 W. 8th St., Chapman, Kansas	\$ 17,530.00	\$ 87,470.00	\$ 105,000.00
Frieze Rentals	728 Broadway Ave., Chapman, Kansas	\$ 12,800.00	\$ 69,440.00	\$ 82,240.00
Daniel Ray	734 Broadway Ave., Chapman, Kansas	\$ 14,420.00	\$ 200,940.00	\$ 215,360.00
Ashley Tonn	321 W. 8th St., Chapman, Kansas	\$ 14,420.00	\$ 129,810.00	\$ 144,230.00
Keith Hartshorn	303 W. 8th St., Chapman, Kansas	\$ 14,420.00	\$ 132,190.00	\$ 146,610.00
Robbi Travelute	301 W. 8th St., Chapman, Kansas	\$ 12,930.00	\$ 124,080.00	\$ 137,010.00
Chandalar Davis	734 Glick Ave., Chapman, Kansas	\$ 7,970.00	\$ 104,620.00	\$ 112,590.00
Kristine Meyer	219 W. 8th St., Chapman, Kansas	\$ 6,470.00	\$ 42,790.00	\$ 49,260.00

Kevin Francis	205 W. 8th St., Chapman, Kansas	\$ 5,910.00	\$ 110,830.00	\$ 116,740.00
Raymond Daisy	727 Sheeran Ave., Chapman, Kansas	\$ 4,450.00	\$ -	\$ 4,450.00
Matthew Whitehair	725 Sheeran Ave., Chapman, Kansas	\$ 4,980.00	\$ 72,490.00	\$ 77,470.00
Harold Oakleaf	700 Block Sheeran Ave., Chapman, Kansas	\$ 3,280.00	\$ -	\$ 3,280.00
Harold Oakleaf	730 Sheeran Ave., Chapman, Kansas	\$ 6,830.00	\$ 92,760.00	\$ 99,590.00
Harold Oakleaf	133 W. 8th St., Chapman, Kansas	\$ 6,330.00	\$ 58,330.00	\$ 64,660.00
Sandra Moritz	125 W. 8th St., Chapman, Kansas	\$ 4,980.00	\$ 94,510.00	\$ 99,490.00
Brent Blocker	117 W. 8th St., Chapman, Kansas	\$ 11,700.00	\$ 177,130.00	\$ 188,830.00
Maria Soria-Martinez	725 Marshall Ave., Chapman, Kansas	\$ 8,720.00	\$ -	\$ 8,720.00
Maria Soria-Martinez	723 Marshall Ave., Chapman, Kansas	\$ 4,490.00	\$ -	\$ 4,490.00
Carl Maxwell	102 W. 7th St., Chapman, Kansas	\$ 16,810.00	\$ -	\$ 16,810.00
Ty Lemon	118 W. 7th St., Chapman, Kansas	\$ 15,200.00	\$ 226,840.00	\$ 242,040.00
Gregory Weller	130 W. 7th St., Chapman, Kansas	\$ 12,360.00	\$ 154,370.00	\$ 166,730.00
Gregory Weller	142 W. 7th St., Chapman, Kansas	\$ 7,350.00	\$ -	\$ 7,350.00
Kevin Francis	723 Sheeran Ave., Chapman, Kansas	\$ 7,220.00	\$ 78,770.00	\$ 85,990.00
Brenda Lacey	701 Sheeran Ave., Chapman, Kansas	\$ 4,430.00	\$ 80,460.00	\$ 84,890.00
William Poff	214 W. 7th St., Chapman, Kansas	\$ 5,640.00	\$ 82,690.00	\$ 88,330.00
Keith Collett	230 W. 7th St., Chapman, Kansas	\$ 13,980.00	\$ 151,200.00	\$ 165,180.00
Robbi Travelute	302 W. 7th St., Chapman, Kansas	\$ 8,400.00	\$ -	\$ 8,400.00
Michael McGarvey	310 W. 7th St., Chapman, Kansas	\$ 12,030.00	\$ 84,140.00	\$ 96,170.00
George Zurmely	318 W. 7th St., Chapman, Kansas	\$ 14,350.00	\$ 47,430.00	\$ 61,780.00
James Manning	330 W. 7th St., Chapman, Kansas	\$ 15,210.00	\$ 114,570.00	\$ 129,780.00
Marilyn Zellers	701 Broadway Ave., Chapman, Kansas	\$ 11,830.00	\$ 171,530.00	\$ 183,360.00
Sarah Tabor	426 W. 7th St., Chapman, Kansas	\$ 9,850.00	\$ 205,150.00	\$ 215,000.00
Krys Burks	438 W. 7th St., Chapman, Kansas	\$ 15,320.00	\$ 115,640.00	\$ 130,960.00
Milborn Hurlbert	705 Logan Ave., Chapman, Kansas	\$ 12,510.00	\$ 206,000.00	\$ 218,510.00
Glenda Dixon	510 W. 7th St., Chapman, Kansas	\$ 29,130.00	\$ 68,740.00	\$ 97,870.00
Katherine Hettenbach	520 W. 7th St., Chapman, Kansas	\$ 16,040.00	\$ 128,760.00	\$ 144,800.00

Heidi Morgan	524 W. 7th St., Chapman, Kansas	\$	15,400.00	\$	97,450.00	\$	112,850.00
Joyce Dickinson	609 W. 7th St., Chapman, Kansas	\$	14,940.00	\$	165,570.00	\$	180,510.00
Helen Rettie	633 Stone Lane, Chapman, Kansas	\$	15,580.00	\$	164,230.00	\$	179,810.00
James Bell	630 Nicholson Rd., Chapman, Kansas	\$	15,720.00	\$	188,590.00	\$	204,310.00
Dennis Kelley	614 Nicholson Rd., Chapman, Kansas	\$	14,960.00	\$	147,240.00	\$	162,200.00
Jean Gobber	500 Block Nicholson Rd., Chapman, Kansas	\$	8,460.00	\$	20,180.00	\$	28,640.00
Matthew Dalke	629 Stone Lane, Chapman, Kansas	\$	12,950.00	\$	107,450.00	\$	120,400.00
James Weller	613 Stone Lane, Chapman, Kansas	\$	13,000.00	\$	127,320.00	\$	140,320.00
Jean Gobber	601 Stone Lane, Chapman, Kansas	\$	13,390.00	\$	158,650.00	\$	172,040.00
Kevin Sage	525 Stone Lane, Chapman, Kansas	\$	19,640.00	\$	236,220.00	\$	255,860.00
Michael Kepka	513 Stone Lane, Chapman, Kansas	\$	16,790.00	\$	146,400.00	\$	163,190.00
Henry Brackney	507 Stone Lane, Chapman, Kansas	\$	14,840.00	\$	133,730.00	\$	148,570.00
Mary Monasmith	502 Stone Lane, Chapman, Kansas	\$	18,460.00	\$	161,860.00	\$	180,320.00
Keegan Mantle	603 W. 6th St., Chapman, Kansas	\$	41,990.00	\$	201,330.00	\$	243,320.00
Tyler Downey	612 Stone Lane, Chapman, Kansas	\$	21,100.00	\$	192,120.00	\$	213,220.00
Dayton Patterson	622 Stone Lane, Chapman, Kansas	\$	21,860.00	\$	119,590.00	\$	141,450.00
Betty Babcock	640 Stone Lane, Chapman, Kansas	\$	14,550.00	\$	121,910.00	\$	136,460.00
BZ Boy Enterprises	523 W. 7th St., Chapman, Kansas	\$	10,000.00	\$	68,800.00	\$	78,800.00
Dewain Krinhop	521 W. 7th St., Chapman, Kansas	\$	22,400.00	\$	95,790.00	\$	118,190.00
City of Chapman	51 W. 7th St., Chapman, Kansas	\$	4,460.00	\$	-	\$	4,460.00
John Merritt	513 W. 7th St., Chapman, Kansas	\$	7,980.00	\$	83,840.00	\$	91,820.00
Dennis Steinour	633 Logan Ave., Chapman, Kansas	\$	11,130.00	\$	90,490.00	\$	101,620.00
C. Russell Zimmerman	625 Logan Ave., Chapman, Kansas	\$	6,950.00	\$	109,460.00	\$	116,410.00
Mark Wendler	630 Logan Ave., Chapman, Kansas	\$	6,530.00	\$	49,600.00	\$	56,130.00
Danny Kirkpatrick	425 W. 7th St., Chapman, Kansas	\$	15,580.00	\$	180,930.00	\$	196,510.00
Wayne Darsow	413 W. 7th St., Chapman, Kansas	\$	16,020.00	\$	99,020.00	\$	115,040.00
Kyle Kinser	633 Broadway Ave., Chapman, Kansas	\$	13,560.00	\$	41,110.00	\$	54,670.00
Clint Clark	625 Broadway Ave., Chapman, Kansas	\$	17,820.00	\$	77,360.00	\$	95,180.00

Richard Boggs	634 Broadway Ave., Chapman, Kansas	\$	4,860.00	\$	120,440.00	\$	125,300.00
Benjamin Deavours	626 Broadway Ave., Chapman, Kansas	\$	13,840.00	\$	122,140.00	\$	135,980.00
Kenneth Shields	313 W. 7th St., Chapman, Kansas	\$	5,300.00	\$	144,180.00	\$	149,480.00
Brad Hartenstein	629 Glick Ave., Chapman, Kansas	\$	6,990.00	\$	168,880.00	\$	175,870.00
Robert Frasier	625 Glick Ave., Chapman, Kansas	\$	6,650.00	\$	171,080.00	\$	177,730.00
Michael Ade	634 Glick Ave., Chapman, Kansas	\$	11,480.00	\$	21,740.00	\$	33,220.00
Lisa Bledsoe	622 Glick Ave., Chapman, Kansas	\$	8,740.00	\$	112,160.00	\$	120,900.00
Kenneth Sims	629 Sheeran Ave., Chapman, Kansas	\$	6,890.00	\$	144,740.00	\$	151,630.00
Jason Krantz	628 Sheeran Ave., Chapman, Kansas	\$	8,170.00	\$	229,250.00	\$	237,420.00
Maria Martinez	133 W. 7th St., Chapman, Kansas	\$	4,790.00	\$	-	\$	4,790.00
Jeff Roudybush	121 W. 7th St., Chapman, Kansas	\$	7,790.00	\$	128,980.00	\$	136,770.00
Greg Cheney	115 W. 7th St., Chapman, Kansas	\$	8,820.00	\$	83,170.00	\$	91,990.00
Mark Perry	625 Marshall Ave., Chapman, Kansas	\$	5,370.00	\$	148,890.00	\$	154,260.00
Treighton Bender	617 Marshall Ave., Chapman, Kansas	\$	8,570.00	\$	190,430.00	\$	199,000.00
Patrick Irvine	613 Marshall Ave., Chapman, Kansas	\$	5,910.00	\$	88,340.00	\$	94,250.00
Ronald Watson	106 W. 6th St., Chapman, Kansas	\$	7,660.00	\$	136,530.00	\$	144,190.00
Ronald Kabat	118 W. 6th St., Chapman, Kansas	\$	5,960.00	\$	-	\$	5,960.00
Shannen Garrison	614 Sheeran Ave., Chapman, Kansas	\$	5,600.00	\$	165,670.00	\$	171,270.00
Ronald Kabat	126 W. 6th St., Chapman, Kansas	\$	8,500.00	\$	141,310.00	\$	149,810.00
Blixt Family Trust	206 W. 6th St., Chapman, Kansas	\$	7,260.00	\$	160,060.00	\$	167,320.00
Terry Strom	214 W. 6th St., Chapman, Kansas	\$	7,660.00	\$	105,780.00	\$	113,440.00
Linda Griffiths	222 W. 6th St., Chapman, Kansas	\$	6,890.00	\$	-	\$	6,890.00
Harold Oakleaf	230 W. 6th St., Chapman, Kansas	\$	7,260.00	\$	66,820.00	\$	74,080.00
Harold Oakleaf	607 Glick Ave., Chapman, Kansas	\$	7,260.00	\$	80,320.00	\$	87,580.00
Kayla Hern	601 Glick Ave., Chapman, Kansas	\$	7,260.00	\$	86,500.00	\$	93,760.00
David Garcia	320 W. 6th St., Chapman, Kansas	\$	5,740.00	\$	110,810.00	\$	116,550.00
Taylor Family Trust	330 W. 6th St., Chapman, Kansas	\$	8,730.00	\$	257,510.00	\$	266,240.00
Michael Klein	609 Broadway Ave., Chapman, Kansas	\$	4,110.00	\$	73,040.00	\$	77,150.00
Joshua Frazier	601 Broadway Ave., Chapman, Kansas	\$	4,650.00	\$	-	\$	4,650.00

Desiree Danler	410 W. 6th St., Chapman, Kansas	\$	5,760.00	\$	64,240.00	\$	70,000.00
Christopher Aguas	418 W. 6th St., Chapman, Kansas	\$	5,760.00	\$	130,290.00	\$	136,050.00
Harold Oakleaf	422 W. 6th St., Chapman, Kansas	\$	13,030.00	\$	44,250.00	\$	57,280.00
BZ Boy Enterprises	430 W. 6th St., Chapman, Kansas	\$	10,020.00	\$	61,630.00	\$	71,650.00
Catherine Bessler	610 Logan Ave., Chapman, Kansas	\$	14,540.00	\$	131,040.00	\$	145,580.00
Bonnie Moen	613 Logan Ave., Chapman, Kansas	\$	10,210.00	\$	91,310.00	\$	101,520.00
Cody Hoferer	601 Logan Ave., Chapman, Kansas	\$	12,940.00	\$	87,480.00	\$	100,420.00
Elizabeth Sites	514 W. 6th St., Chapman, Kansas	\$	4,680.00	\$	96,060.00	\$	100,740.00
Rodney Root	526 W. 6th St., Chapman, Kansas	\$	21,950.00	\$	152,390.00	\$	174,340.00
Dennis Will	534 W. 6th St., Chapman, Kansas	\$	11,800.00	\$	160,650.00	\$	172,450.00
Steven Miller	525 W. 6th St., Chapman, Kansas	\$	16,100.00	\$	194,590.00	\$	210,690.00
Leon Morton	521 W. 6th St., Chapman, Kansas	\$	16,100.00	\$	44,250.00	\$	60,350.00
Timothy Stoner	525 Logan Ave., Chapman, Kansas	\$	14,500.00	\$	158,990.00	\$	173,490.00
Nels Espeseth	521 Logan Ave., Chapman, Kansas	\$	8,500.00	\$	28,920.00	\$	37,420.00
Lindsay Krinhop	517 Logan Ave., Chapman, Kansas	\$	11,500.00	\$	33,210.00	\$	44,710.00
Martin Wilbur	509 Logan Ave., Chapman, Kansas	\$	11,500.00	\$	79,610.00	\$	91,110.00
Noah Rice	526 Logan Ave., Chapman, Kansas	\$	14,540.00	\$	58,020.00	\$	72,560.00
Michael Wahlmeier	425 W. 6th St., Chapman, Kansas	\$	16,040.00	\$	124,380.00	\$	140,420.00
David Whitley	417 W. 6th St., Chapman, Kansas	\$	13,030.00	\$	42,160.00	\$	55,190.00
Ryan Opat	415 W. 6th St., Chapman, Kansas	\$	14,530.00	\$	39,870.00	\$	54,400.00
Jeana Baker	529 Broadway Ave., Chapman, Kansas	\$	9,790.00	\$	86,510.00	\$	96,300.00
Harold Oakleaf	521 Broadway Ave., Chapman, Kansas	\$	9,110.00	\$	57,920.00	\$	67,030.00
Emmely, LLC	530 Broadway Ave., Chapman, Kansas	\$	8,740.00	\$	78,930.00	\$	87,670.00
Eileen Woodworth	518 Broadway Ave., Chapman, Kansas	\$	4,250.00	\$	103,660.00	\$	107,910.00
Raymond Sawyer	514 Broadway Ave., Chapman, Kansas	\$	5,750.00	\$	43,710.00	\$	49,460.00
Chad Duer	529 Glick Ave., Chapman, Kansas	\$	4,250.00	\$	-	\$	4,250.00
Robert Sayers	521 Glick Ave., Chapman, Kansas	\$	7,240.00	\$	82,310.00	\$	89,550.00
Andrew Smith	515 Glick Ave., Chapman, Kansas	\$	14,340.00	\$	98,610.00	\$	112,950.00
Jana Clark	227 W. 6th St., Chapman, Kansas	\$	4,100.00	\$	226,720.00	\$	230,820.00

Michael Rowley	518 Glick Ave., Chapman, Kansas	\$	4,350.00	\$	-	\$	4,350.00
Logan Lehmkuhl	529 Sheeran Ave., Chapman, Kansas	\$	10,260.00	\$	163,000.00	\$	173,260.00
Chance Hultgren	517 Sheeran Ave., Chapman, Kansas	\$	9,000.00	\$	155,880.00	\$	164,880.00
Chance Hultgren	500 Block Sheeran Ave., Chapman, Kansas	\$	2,070.00	\$	-	\$	2,070.00
Brian Sweet	526 Sheeran Ave., Chapman, Kansas	\$	14,230.00	\$	188,510.00	\$	202,740.00
Clinton Thornton	518 Sheeran Ave., Chapman, Kansas	\$	14,430.00	\$	161,340.00	\$	175,770.00
First Methodist Church	516 Sheeran Ave., Chapman, Kansas	\$	13,500.00	\$	146,330.00	\$	159,830.00
ARCO Funeral Company	206 W. 5th St., Chapman, Kansas	\$	10,210.00	\$	117,130.00	\$	127,340.00
Gary Kolling	210 W. 5th St., Chapman, Kansas	\$	5,750.00	\$	-	\$	5,750.00
Johnny Anderson	506 Glick Ave., Chapman, Kansas	\$	5,750.00	\$	143,420.00	\$	149,170.00
Darrel Stewart	302 W. 5th St., Chapman, Kansas	\$	4,810.00	\$	194,570.00	\$	199,380.00
Robert Sayers	310 W. 5th St., Chapman, Kansas	\$	3,690.00	\$	-	\$	3,690.00
Meagan Schlappy	324 W. 5th St., Chapman, Kansas	\$	5,750.00	\$	-	\$	5,750.00
Kristina Schlappy	502 Broadway Ave., Chapman, Kansas	\$	4,020.00	\$	127,850.00	\$	131,870.00
Harold Oakleaf	501 Broadway Ave., Chapman, Kansas	\$	8,390.00	\$	62,940.00	\$	71,330.00
Trevor Mosher	406 W. 5th St., Chapman, Kansas	\$	11,630.00	\$	94,920.00	\$	106,550.00
Anthony Wuthnow	410 W. 5th St., Chapman, Kansas	\$	14,530.00	\$	134,310.00	\$	148,840.00
Margaret Irvine	422 W. 5th St., Chapman, Kansas	\$	14,530.00	\$	89,270.00	\$	103,800.00
Michael Brown	436 W. 5th St., Chapman, Kansas	\$	14,530.00	\$	97,920.00	\$	112,450.00
Jason Tiller	438 W. 5th St., Chapman, Kansas	\$	14,540.00	\$	151,770.00	\$	166,310.00
USD 473	505 Logan Ave., Chapman, Kansas	\$	11,300.00	\$	68,670.00	\$	79,970.00
City of Chapman	516 W. 5th St., Chapman, Kansas	\$	5,700.00	\$	-	\$	5,700.00
James McGuire	522 W. 5th St., Chapman, Kansas	\$	6,760.00	\$	212,680.00	\$	219,440.00
Emmely, LLC	530 W. 5th St., Chapman, Kansas	\$	13,880.00	\$	47,090.00	\$	60,970.00
Jean Detrich	538 W. 5th St., Chapman, Kansas	\$	18,510.00	\$	123,830.00	\$	142,340.00
Daniel Witt	429 Sheeran Ave., Chapman, Kansas	\$	14,360.00	\$	160,220.00	\$	174,580.00
Nicki Shry	417 Sheeran Ave., Chapman, Kansas	\$	14,510.00	\$	87,820.00	\$	102,330.00
Mark Tiller	225 W. 5th St., Chapman, Kansas	\$	14,510.00	\$	174,800.00	\$	189,310.00

Gary Marshall	422 Glick Ave., Chapman, Kansas	\$	10,260.00	\$	42,250.00	\$	52,510.00
David Edghill	311 W. 5th St., Chapman, Kansas	\$	5,250.00	\$	163,550.00	\$	168,800.00
Endeavor Property Management	419 Glick Ave., Chapman, Kansas	\$	5,000.00	\$	67,390.00	\$	72,390.00
Lucas Cole	313 W. 5th St., Chapman, Kansas	\$	4,750.00	\$	145,250.00	\$	150,000.00
Pete Cosio	525 W. 5th St., Chapman, Kansas	\$	10,500.00	\$	187,250.00	\$	197,750.00
Gregory Perkins	529 W. 5th St., Chapman, Kansas	\$	13,770.00	\$	102,210.00	\$	115,980.00
Adam Wooldridge	545 W. 5th St., Chapman, Kansas	\$	32,020.00	\$	147,730.00	\$	179,750.00
Gerald Aramowicz	437 Stone Lane, Chapman, Kansas	\$	12,800.00	\$	125,670.00	\$	138,470.00
Doreen Kanode	425 Nicholson Rd., Chapman, Kansas	\$	12,790.00	\$	107,800.00	\$	120,590.00
Cody Fansler	413 Nicholson Rd., Chapman, Kansas	\$	10,940.00	\$	135,080.00	\$	146,020.00
Rick Hall	401 Nicholson Rd., Chapman, Kansas	\$	17,580.00	\$	126,230.00	\$	143,810.00
Clinton Thornton	500 Block W. 4th St., Chapman, Kansas	\$	11,800.00	\$	-	\$	11,800.00
Terra Daisy	522 W. 4th St., Chapman, Kansas	\$	9,250.00	\$	93,740.00	\$	102,990.00
Janice Warhurst	222 W. 4th St., Chapman, Kansas	\$	13,760.00	\$	70,880.00	\$	84,640.00
Fracis Seymour-Hunter	210 W. 4th St., Chapman, Kansas	\$	11,380.00	\$	52,450.00	\$	63,830.00
Joshua Frazier	415 Sheeran Ave., Chapman, Kansas	\$	3,750.00	\$	63,010.00	\$	66,760.00
Terry Strom	202 W. 4th St., Chapman, Kansas	\$	6,250.00	\$	87,710.00	\$	93,960.00
Cathy Fahey	414 Sheeran Ave., Chapman, Kansas	\$	1,940.00	\$	85,660.00	\$	87,600.00
Mark Johnston	412 Sheeran Ave., Chapman, Kansas	\$	8,360.00	\$	96,460.00	\$	104,820.00
Elizabeth Boltz-Morton	402 Sheeran Ave., Chapman, Kansas	\$	4,400.00	\$	69,500.00	\$	73,900.00
City of Chapman	701 W. 5th St., Chapman, Kansas	\$	20,600.00	\$	5,000.00	\$	25,600.00
Gary Oesterhaus	704 W. 4th St., Chapman, Kansas	\$	6,160.00	\$	83,140.00	\$	89,300.00
Terry Root	712 W. 4th St., Chapman, Kansas	\$	38,390.00	\$	129,860.00	\$	168,250.00
Howard Battishill	716 W. 4th St., Chapman, Kansas	\$	16,120.00	\$	195,180.00	\$	211,300.00
Thomas Bishop	720 W. 4th St., Chapman, Kansas	\$	34,670.00	\$	184,810.00	\$	219,480.00
Lynn Battishill	722 W. 4th St., Chapman, Kansas	\$	20,670.00	\$	100,050.00	\$	120,720.00
Kenneth McPherson	703 W. 5th St., Chapman, Kansas	\$	27,650.00	\$	212,200.00	\$	239,850.00
Favio Garcia	715 W. 5th St., Chapman, Kansas	\$	19,910.00	\$	167,620.00	\$	187,530.00
Jacob Bales-Henry	719 W. 5th St., Chapman, Kansas	\$	17,370.00	\$	173,430.00	\$	190,800.00

George Maior	721 W. 5th St., Chapman, Kansas	\$ 20,680.00	\$ 155,100.00	\$ 175,780.00
Genevieve Larson	723 W. 5th St., Chapman, Kansas	\$ 19,440.00	\$ 215,340.00	\$ 234,780.00
Stashia Hardman	700 Block W. 5th St., Chapman, Kansas	\$ 21,980.00	\$ -	\$ 21,980.00
Stashia Hardman	729 W. 5th St., Chapman, Kansas	\$ 13,400.00	\$ 258,580.00	\$ 271,980.00
Greg Weller	733 W. 5th St., Chapman, Kansas	\$ 11,400.00	\$ 271,810.00	\$ 283,210.00
Joshua Coltrain	516 Golf Course Rd., Chapman, Kansas	\$ 27,400.00	\$ 240,050.00	\$ 267,450.00
Shane Wilson	518 Hilltop Dr., Chapman, Kansas	\$ 12,120.00	\$ 219,400.00	\$ 231,520.00
Daniel Taylor	514 Hilltop Dr., Chapman, Kansas	\$ 18,490.00	\$ 172,220.00	\$ 190,710.00
Harold Bordelon	508 Hilltop Dr., Chapman, Kansas	\$ 18,790.00	\$ 154,330.00	\$ 173,120.00
Jesse Kerns	728 W. 5th St., Chapman, Kansas	\$ 18,950.00	\$ 230,010.00	\$ 248,960.00
Mandic Family Trust	501 Crestview Dr., Chapman, Kansas	\$ 19,500.00	\$ 228,050.00	\$ 247,550.00
Savanna Rogstad	503 Crestview Dr., Chapman, Kansas	\$ 19,340.00	\$ 189,780.00	\$ 209,120.00
Marc Schmidt	505 Crestview Dr., Chapman, Kansas	\$ 18,980.00	\$ 164,140.00	\$ 183,120.00
Paul Wright	506 Crestview Dr., Chapman, Kansas	\$ 28,510.00	\$ 182,510.00	\$ 211,020.00
Kevin Hawes	508 Crestview Dr., Chapman, Kansas	\$ 17,830.00	\$ 144,080.00	\$ 161,910.00
Charles Adams	510 Crestview Dr., Chapman, Kansas	\$ 18,140.00	\$ 225,680.00	\$ 243,820.00
Tanya Brabender	512 Crestview Dr., Chapman, Kansas	\$ 18,330.00	\$ 255,440.00	\$ 273,770.00
Mary Devin	500 Block Cedar Dr., Chapman, Kansas	\$ 19,420.00	\$ -	\$ 19,420.00
Tommy Smith	509 Cedar Dr., Chapman, Kansas	\$ 18,050.00	\$ 166,400.00	\$ 184,450.00
Steven Hawes	513 Cedar Dr., Chapman, Kansas	\$ 17,780.00	\$ 153,160.00	\$ 170,940.00
Lydia Blixt	502 Cedar Dr., Chapman, Kansas	\$ 13,250.00	\$ 81,770.00	\$ 95,020.00
Larry Steppe	503 Meadow Dr., Chapman, Kansas	\$ 13,740.00	\$ 117,410.00	\$ 131,150.00
Sandra Acker	505 Meadow Dr., Chapman, Kansas	\$ 12,950.00	\$ 115,130.00	\$ 128,080.00
Debra Dreilling	509 Meadow Dr., Chapman, Kansas	\$ 12,360.00	\$ 118,510.00	\$ 130,870.00
Rocklyn Sanders	513 Meadow Dr., Chapman, Kansas	\$ 13,790.00	\$ 147,400.00	\$ 161,190.00
Steven Lacer	516 Meadow Dr., Chapman, Kansas	\$ 22,560.00	\$ 128,580.00	\$ 151,140.00
Joyce Jackson	514 Meadow Dr., Chapman, Kansas	\$ 18,080.00	\$ 156,010.00	\$ 174,090.00
Rea Tedder	510 Meadow Dr., Chapman, Kansas	\$ 15,200.00	\$ 199,540.00	\$ 214,740.00
Joshua Frazier	508 Meadow Dr., Chapman, Kansas	\$ 15,700.00	\$ 178,170.00	\$ 193,870.00

Mervin Wiese	506 Meadow Dr., Chapman, Kansas	\$ 17,420.00	\$ 164,220.00	\$ 181,640.00
Harold Oakleaf	629 Nicholson Rd., Chapman, Kansas	\$ 39,670.00	\$ 152,300.00	\$ 191,970.00
Jessie Jackson	701 Oakhill Dr., Chapman, Kansas	\$ 23,980.00	\$ 191,900.00	\$ 215,880.00
Lance Tilton	711 Oakhill Dr., Chapman, Kansas	\$ 13,940.00	\$ 150,340.00	\$ 164,280.00
Megan Gaeta	715 Oakhill Dr., Chapman, Kansas	\$ 25,380.00	\$ 231,960.00	\$ 257,340.00
Jennifer Heller	719 Oakhill Dr., Chapman, Kansas	\$ 17,210.00	\$ 169,030.00	\$ 186,240.00
Gregory Beaulieu	723 Oakhill Dr., Chapman, Kansas	\$ 18,080.00	\$ 208,150.00	\$ 226,230.00
Jacob Elmore	727 Oakhill Dr., Chapman, Kansas	\$ 21,110.00	\$ 205,520.00	\$ 226,630.00
Ryan Grubb	733 Oakhill Dr., Chapman, Kansas	\$ 20,770.00	\$ 207,300.00	\$ 228,070.00
Lee Kenner	739 Oakhill Dr., Chapman, Kansas	\$ 9,230.00	\$ 265,050.00	\$ 274,280.00
Jack Gunderson	738 Oakhill Dr., Chapman, Kansas	\$ 25,880.00	\$ 210,530.00	\$ 236,410.00
Shawn Sherraden	728 Oakhill Dr., Chapman, Kansas	\$ 36,250.00	\$ 192,880.00	\$ 229,130.00
Charles DeBerge	722 Oakhill Dr., Chapman, Kansas	\$ 35,060.00	\$ 210,580.00	\$ 245,640.00
Glenn Cook	821 Nicholson Rd., Chapman, Kansas	\$ 22,880.00	\$ 227,020.00	\$ 249,900.00
Daniel Avevedo	823 Nicholson Rd., Chapman, Kansas	\$ 21,120.00	\$ 217,040.00	\$ 238,160.00
Frank Smith	835 Nicholson Rd., Chapman, Kansas	\$ 19,040.00	\$ 263,390.00	\$ 282,430.00
Matthew Carlsson	837 Nicholson Rd., Chapman, Kansas	\$ 19,920.00	\$ 145,080.00	\$ 165,000.00
Bonnie Moen	901 Nicholson Rd., Chapman, Kansas	\$ 20,800.00	\$ 232,760.00	\$ 253,560.00
Leland Welsh	911 Nicholson Rd., Chapman, Kansas	\$ 21,680.00	\$ 201,490.00	\$ 223,170.00
David Sproat	00000 Nicholson Rd., Chapman, Kansas	\$ 22,560.00	\$ -	\$ 22,560.00
David Sproat	919 Nicholson Rd., Chapman, Kansas	\$ 32,590.00	\$ 237,570.00	\$ 270,160.00
Marc Riegel	926 Nicholson Rd., Chapman, Kansas	\$ 16,930.00	\$ 187,320.00	\$ 204,250.00
Tyler Herrington	924 Nicholson Rd., Chapman, Kansas	\$ 17,490.00	\$ 236,790.00	\$ 254,280.00
Kenneth Sherraden	922 Nicholson Rd., Chapman, Kansas	\$ 17,010.00	\$ 183,520.00	\$ 200,530.00
Rick Johnson	916 Nicholson Rd., Chapman, Kansas	\$ 17,010.00	\$ 193,340.00	\$ 210,350.00
Timothy Jury	910 Nicholson Rd., Chapman, Kansas	\$ 16,950.00	\$ 208,670.00	\$ 225,620.00
John Opat	832 Nicholson Rd., Chapman, Kansas	\$ 23,680.00	\$ 169,380.00	\$ 193,060.00
David Anderson	828 Nicholson Rd., Chapman, Kansas	\$ 28,000.00	\$ 166,960.00	\$ 194,960.00
Blixt Construction, LLC	1206 St. Patrick's Dr., Chapman, Kansas	\$ 17,520.00	\$	\$ 17,520.00

Blixt Construction, LLC	1208 St. Patrick's Dr., Chapman, Kansas	\$	18,020.00	\$	\$	18,020.00
Blixt Construction, LLC	1210 St. Patrick's Dr., Chapman, Kansas	\$	18,020.00	\$	\$	18,020.00
John Childs	1213 St. Patrick's Dr., Chapman, Kansas	\$	15,600.00	\$	\$	15,600.00
Blixt Construction, LLC	1218 St. Patrick's Dr., Chapman, Kansas	\$	19,200.00	\$	\$	19,200.00
JLC Companies, LLC	1217 St. Patrick's Dr., Chapman, Kansas	\$	15,600.00	\$	\$	15,600.00
Blixt Construction, LLC	1200 Block, St. Patrick's Dr., Chapman, Kansas	\$	24,180.00	\$	\$	24,180.00

APPENDIX D
NEIGHBORHOOD REVITALIZATION TAX REBATE APPLICATION

CITY OF CHAPMAN
NEIGHBORHOOD REVITALIZATION PROGRAM
TAX REBATE APPLICATION

INSTRUCTIONS: This application and all required information must be submitted in accordance with the Chapman Neighborhood Revitalization Program (Resolution # _____) and all applicable administrative procedures. All information requested in this application must be answered completely.

PART I: PRE-IMPROVEMENT INFORMATION

APPLICATION INFORMATION

APPLICATION FOR (Check Appropriate Box):

- ☐ New Commercial Construction
- ☐ Addition/Improvement of Existing
- ☐ New Residential Construction

FOR OFFICIAL USE ONLY

Application #: _____
Date Received: _____
Received By: _____
Building Permit #: _____

BRIEF DESCRIPTION OF IMPROVEMENTS BEING MADE:

LAND USE: Primary Use _____ Secondary Use _____ Other _____

APPLICANT INFORMATION

APPLICANT/AGENT (If Not Property Owner):

Name: _____ Tel: (____) _____
Business Name: _____ Fax: (____) _____
Address: _____
City: _____ State: _____ Zip Code: _____
Email: _____

PROPERTY OWNER (If Different from Applicant/Agent):

Name: _____ Tel: (____) _____

Business Name: _____ Fax: (____) _____

Address: _____

City: _____ State: _____ Zip Code: _____

Email: _____

GENERAL PROPERTY INFORMATION

PROPERTY ADDRESS OR GENERAL LOCATION (IN RELATION TO NEAREST STREETS):

PROPERTY TAX IDENTIFICATION NUMBER: _____

ZONING: Existing: _____ Proposed: _____

LAND USE: Existing: _____ Proposed: _____

GROSS SIZE OF PLAT/LOT:

Residential: _____ Commercial: _____ Industrial: _____ Other: _____ Total: _____

NUMBER OF LOTS:

Residential: _____ Commercial: _____ Industrial: _____ Other: _____ Total: _____

EXISTING PUBLIC FACILITIES:

	Public	Private	Other (Describe)
Water Service:	<input type="checkbox"/>	<input type="checkbox"/>	<input type="checkbox"/> _____
Sewer Service:	<input type="checkbox"/>	<input type="checkbox"/>	<input type="checkbox"/> _____
Roadway Access:	<input type="checkbox"/>	<input type="checkbox"/>	<input type="checkbox"/> _____

FLOODPLAIN INFORMATION:

Located in Floodplain: ☐ Yes ☐ No If Yes, Floodplain regulations apply.

Structure will be floodproofed by: ☐ Elevation ☐ Design

ARE ANY OTHER PERMITS OR DEVELOPMENT APPROVALS REQUIRED FOR THE APPLICATION PROPERTY BY THE CITY OR ANY OTHER JURISDICTION OR AGENCY?

☐ Yes ☐ No If yes, describe and attach a copy of each permit (Approval or Application)

PROPERTY IMPROVEMENT INFORMATION*

IMPROVEMENT CHARACTERISTICS:

Number of Buildings or Structures: _____ Number of Dwellings: _____
Buildings/Structure Depth: _____ ft. Building/Structure Width: _____ ft.
Existing Floor Area: _____ sq. ft. New Floor Area: _____ sq. ft.
Total Building Area: _____ sq. ft. Roof/Overhang: _____ sq. ft.
Maximum Height of Buildings or Structures: _____ ft. Total Impervious Area: _____
Stories Above Grade: _____ Stories Below Grade: _____ Total Number of Stories _____
Basement: ☐ Finished ☐ Unfinished ☐ None

I acknowledge receipt of the Neighborhood Revitalization Program guidelines. I realize that this application will not be processed unless it is completed in its entirety and is accompanied by all necessary supporting documents. I certify that the foregoing information is true and accurate to the best of my knowledge.

Applicant Signature

Date

Property Owner Signature

Date

*This Application must bear the signature(s) of the property owner(s). If an authorized agent signs on the owner's behalf, the agent shall sign his/her name and attach the owner's written notarized authorization to this Application.

DOCUMENTS TO BE SUBMITTED WITH APPLICATION AND APPLICATION REVIEW

☐ Copy of Deed ☐ Building Permit ☐ Other _____

A list of additional documents required were provided to the applicant on _____, 20____. The applicant is hereby advised that the application will not be accepted for staff review until the identified documents are submitted and a Determination of Complete Application is certified. In addition, I certify that the Neighborhood Revitalization Program Application and attached documents are sufficient in form and content to allow City and County staff to sufficiently review the development action for conformance with all applicable local laws. This certification does not preclude City or County staff from requesting additional information as deemed necessary to serve the public interest. This determination does not represent a finding of compliance with applicable local laws, nor does it confer a vested right to the applicant or owner of the property in question.

Signature of Chapman City Administrator

Date

PART I: PRE-IMPROVEMENT VALUE CERTIFICATION

Value of existing primary structure improvements: \$ _____

Value of land on which the improvements are situated: \$ _____

DETERMINATION OF COMPLETE APPLICATION:

I certify that the pre-improvement values indicated above are those certified by Dickinson County for the current tax year as of the date of this certification.

Signature of County Appraiser

Date

PART II: IMPROVEMENT UPDATE

As of January 1st, 20____, following the commencement of improvements the project is:

☐ Complete ☐ Incomplete ☐ Abandoned

Signature of Applicant

Date

Value of existing primary structure improvements: \$ _____

Value of the land on which the improvements are situated: \$ _____

DETERMINATION OF COMPLETE APPLICATION:

I certify that the pre-improvement values indicated above are those certified by Dickinson County for the current tax year as of the date of this certification.

Signature of County Appraiser

Date

As of _____, 20____, taxes and special assessments on this parcel ☐ are ☐ are not delinquent.

Signature of County Clerk

Date

As of _____, 20____, there ☐ are ☐ are not bills or city liens payable by the owners of this property.

Signature of City Clerk

Date

The above application and improvements ☐ are ☐ are not in conformance with the requirements for the City of Chapman Neighborhood Revitalization Program. If in conformance, a tax rebate is hereby authorized subject to the terms of the Neighborhood Revitalization Program as applicable on this date.

Reason if not in conformance:

Signature of City Administrator

Date